

ODFW AQUATIC INVENTORY PROJECT
OREGON PLAN FOR SALMON & WATERSHEDS
STREAM RESTORATION HABITAT REPORT

STREAM: Taylor Creek (SC-274)
BASIN: Pacific Ocean
SURVEY TYPE: Pre-Tx
DATE: March 11, 2005
SURVEY CREW: Jennifer Schmitt, Neil Jensen
REPORT PREPARED BY: Paul Jacobsen
BASIN AREA: 4.6 km²
USGS MAPS: Brookings
ECOREGION: Southern Oregon Coastal Mountains

GENERAL DESCRIPTION:

The Taylor Creek habitat survey extended 2,036 meters. The channel was constrained by hillslopes in a moderate V-shaped valley. The average valley width index was 4.4 (range: 1.1-10.2). Land use for the reach was timber harvest and rural residential. The average unit gradient was 4.0 percent. Rapids (37%) and cascades (28%) dominated stream habitat. Gravel (45%) dominated stream substrate. Wood volume was low at 15.8 m³/100m.

COMMENTS:

There were no potential barriers to upstream fish migration in the surveyed length.

REACH 1

T40S-R14W-S26SE

REACH 1

Valley and Channel Summary

Valley Characteristics (Percent Reach Length)

<u>Narrow Valley Floor</u>		<u>Broad Valley Floor</u>	
Steep V-shape	0%	Constraining Terraces	0%
Moderate V-shape	100%	Multiple Terraces	0%
Open V-shape	0%	Wide Floodplain	0%
Valley Width Index	4.4	VWI Range:	1.1 - 10.2

Channel Morphology (Percent Reach Length)

<u>Constrained</u>		<u>Unconstrained</u>	
Hillslope	100%	Single Channel	0%
Bedrock	0%	Multiple Channel	0%
Terrace	0%	Braided Channel	0%
Alt. Terrace/Hill	0%		
Landuse	0%		

Channel Characteristics

<u>Type</u>	<u>Length (m)</u>	<u>Area (m2)</u>	<u>Dry Units</u>
Primary Channel	2,036	7,144	0
Secondary Channel	16	6	1
Off-Channel Units	36	88	0

Channel Dimensions (m)

<u>Wetted</u>	<u>Active</u>	<u>Floodprone</u> n = 10	<u>First Terrace</u> n = 6
Width: 3.6	Width: 7.5	12.1 (8.9 - 15.9)	14.4 (9.3 - 18.9)
Depth: 0.35	Height: 0.5	1.1 (1.02 - 1.1)	1.5 (1.12 - 3)

W:D ratio: 14.1

Entrenchment (ACW:FPW ratio): 1.7

Stream Flow Type: LF

Habitat Units/100m (total channel length): 5.9

Average Unit Gradient: 4.0%

Habitat Units/100m (primary channel length): 6.1

Water temperature (°C): 9.0 - 9.0

Riparian, Bank, and Wood Summary

	<u>Primary</u>	<u>Secondary</u>
Land Use:	TH	RR
Riparian Vegetation:	D30	S

Bank Condition and Shade

<u>Bank Status</u>	<u>Percent Reach Length</u>	<u>Shade (% of 180)</u>
Actively Eroding:		Reach avg:
Undercut Banks:		Range: -

Large Wood Debris

	<u>Total</u>	<u>Total / 100m primary channel</u>
All pieces (>=3m x 0.15m):	298	14.6
Volume (m ³):	321	15.8
Key pieces (>=12m x 0.60m):	7	0.3

OREGON DEPT OF FISH AND WILDLIFE

TAYLOR CREEK PRE-TX (5-SC, 274)

HABITAT INVENTORY

Report Date: 11/29/2005

Survey Date:

3/11/2005

REACH 1

T40S-R14W-S26SE

REACH 1

HABITAT DETAIL

Habitat Type	Number Units	Total Length (m)	Avg Width (m)	Avg Depth (m)	Total Area (m ²)	Large Boulders (#>0.5m)	Substrate Percent Wetted Area					
							S/O	Snd	Grvl	Cbl	Bldr	Bdrk
CASCADE/BOULDERS	26	581	3.4	0.20	2,007	0	6	13	46	21	13	3
CULVERT CROSSING	1	100	1.6	0.15	160	0	0	0	5	5	0	90
POOL-BACKWATER	4	19	2.8	0.63	60	0	32	59	1	1	5	2
POOL-DAMMED	3	40	3.6	0.85	143	0	17	48	14	5	11	5
POOL-LATERAL SCOUR	22	253	4.0	0.75	991	0	12	30	42	8	5	3
POOL-PLUNGE	8	51	5.6	0.85	279	0	12	30	45	4	5	4
POOL-STRAIGHT SCOUR	1	5	4.8	0.75	24	0	10	15	50	10	15	0
PUDDLED UNIT	1	16	0.4	0.01	6	0	19	38	10	29	5	0
RAPID/BOULDERS	30	775	3.6	0.15	2,693	0	4	12	55	19	9	1
RIFFLE	12	178	3.6	0.20	652	0	5	19	58	11	5	1
RIFFLE W/ POCKETS	2	33	3.3	0.33	106	0	10	34	39	15	3	0
STEP/BEDROCK	2	2	2.2	0.10	4	0	0	3	26	20	21	31
STEP/BOULDERS	2	4	2.1	0.05	8	0	0	0	18	18	64	0
STEP/COBBLE	5	25	3.5	0.11	90	0	2	2	68	20	6	2
STEP/LOG	3	2	2.3	0.03	4	0	3	20	57	13	0	7
STEP/STRUCTURE	2	4	3.4	0.04	13	0	0	0	5	7	38	50
Total:	124	2,088	3.6	0.35	7,238	0	Avg: 8	19	45	14	9	4

HABITAT SUMMARY

Habitat Group	Number Units	Total Length (m)	Avg Width (m)	Avg Depth (m)	Wetted Area		Large Boulders	
					(m ²)	Percent	Number	(# / 100m ²)
Dammed & BW Pools	7	59	3.1	0.72	203	2.80%	0	0.0
Scour Pools	31	309	4.4	0.77	1,293	17.87%	0	0.0
Glides	0	0			0	0.00%	0	0.0
Riffles	14	211	3.5	0.22	758	10.47%	0	0.0
Rapids	30	775	3.6	0.15	2,693	37.21%	0	0.0
Cascades	26	581	3.4	0.20	2,007	27.72%	0	0.0
Step/Falls	14	37	2.8	0.07	118	1.63%	0	0.0
Dry	1	16	0.4	0.01	6	0.08%	0	0.0
Culverts	1	100	1.6	0.15	160	2.21%	0	0.0

REACH 1

T40S-R14W-S26SE

REACH 1

POOL SUMMARY

	<u>Total</u>	Total of all Channel Lengths <u># / Km</u>	Primary Channel Length <u># / Km</u>
All Pools:	38	18.2	18.7
Pools >=1m deep:	7	3.4	3.4
Complex pools (LWD pieces>=3):	9	4.3	4.4
Pool frequency (channel widths/pool):	7.4		
Residual pool depth (avg):	0.59		

Comment Summary

Restoration Monitoring Sites 2005

MONITORING AREA: **5-SC** SITE ID: **274** TAYLOR CREEK PRE-TX

UNIT#	TYPE	CHAN	DIST. (m)	COMMENTS	NOTE ESTIMATOR	NOTE NUMERATOR
2	SB	00	8.2		H = 1.15	
3	PP	00	13.3		BEDROCK = CONCRETE	
4	SS	00	13.8		H = .7, BEDROCK - CONCRETE	
5	CC	00	113.9	CC	BEDROCK=CONCRETE, HWY 101	
6	CB	00	125.3	/CE		
8	SR	00	130.6		H = .4	
12	CB	00	173.6	WL	VOLE	
13	LP	00	189.2		SALMONID FRY	
14	RB	00	216.3	/SS		
15	CB	01	239.8	WL	WILDLIFE TRAIL	
16	BW	10	239.8	DJ	SALMONID FRY	
22	LP	00	331.3	/SS		
24	LP	00	364.4	SS/		
27	RB	01	393.6	TJ/		
30	LP	00	415.3	/SS		
33	SL	00	436.8		H = .55	
38	RB	00	509	WL	RACCOON TRACKS	
40	LP	00	558.7	/LA/SS, WL	RACCOON TRACKS	
44	LP	00	573.4	WL	REDD, SALMONID FRY	
47	PP	00	593.6		SMALL STEP BETWEEN POOLS	
49	RB	00	636.8	/SS		

Comment Summary

Restoration Monitoring Sites 2005

MONITORING AREA: 5-SC SITE ID: 274 TAYLOR CREEK PRE-TX

UNIT#	TYPE	CHAN	DIST. (m)	COMMENTS	NOTE ESTIMATOR	NOTE NUMERATOR
50	CB	00	651.2	SS/	POWERLINE CROSSING	
56	CB	00	793.5		CH MV D30 S LG RR	
57	SR	00	794.6		H = 1.2M	
59	BW	10	804.6	/SS		
61	SS	00	815		ROCK DAM	
62	DP	00	827.2		PIPES DRAWING WATER FROM POOL	
63	RB	00	846.2	/SS, WL	RACCOON TRACKS	
65	SL	00	854	DJ	H = 0.75M	
66	DP	00	868.8		5ML x 1MH RUBBER CURTAIN OVER	
68	CB	01	931.1	/SS, WL	WILDLIFE TRAIL	
71	LP	00	993.3	SS/, DJ	CH MV D15 S TH LG	
73	RI	00	1026.6	SS/		
74	SB	00	1028.1		H = 0.48M	
76	RI	00	1088.7	WL	REDD	
77	CB	00	1106	/SS		
79	RB	00	1129.2	/SS		
81	RB	01	1172.9	/TJ	TRIB 2	
82	CB	11	1172.9		ACH 0.35, ACW 2.5	
83	RB	00	1188.5	WL	FALCON	
86	CB	00	1240	SS/	CH MV S G TH ST	
87	DP	00	1253.1		SANDBAG AND BOULDER DAM, PIPES	

Comment Summary

Restoration Monitoring Sites 2005

MONITORING AREA: **5-SC** SITE ID: **274** TAYLOR CREEK PRE-TX

UNIT#	TYPE	CHAN	DIST. (m)	COMMENTS	NOTE ESTIMATOR	NOTE NUMERATOR
88	RB	00	1260.9	/SS RF WL		RACCOON TRACKS
89	LP	00	1270.9	WL SS/ BC		SMALL MAMMAL CARCASS, FOOTBRID
91	RB	00	1336.1	/SS		
92	PP	00	1343.7	WL		RACCOON CARCASS
93	SL	00	1344			H = 0.25M
99	RP	00	1520.7			CH MV D30 S TH LT
102	CB	00	1661.7	/LA		8M x 25M
103	LP	00	1673.2			SALMONID FRY
104	RB	00	1717.4	SS/ DJ LS/		10M x 8M
107	RB	00	1751.4			CH MV D30 S TH
108	CB	01	1779.2	/SS		
113	LP	00	1843.8	SS/		
115	BW	10	1862.4	/SS		
116	RI	00	1875	WL		COUGAR TRACK
118	CB	00	1933.1	/LA		3M x 2M
120	CB	00	1963.4	RF		
121	RI	00	1990.6	WL		RACCOON TRACKS
122	RB	00	2005.9			CL CT D30 S TH
123	LP	00	2017.1			SALMONID FRY
124	RB	00	2035.6			CT CT D30 S TH

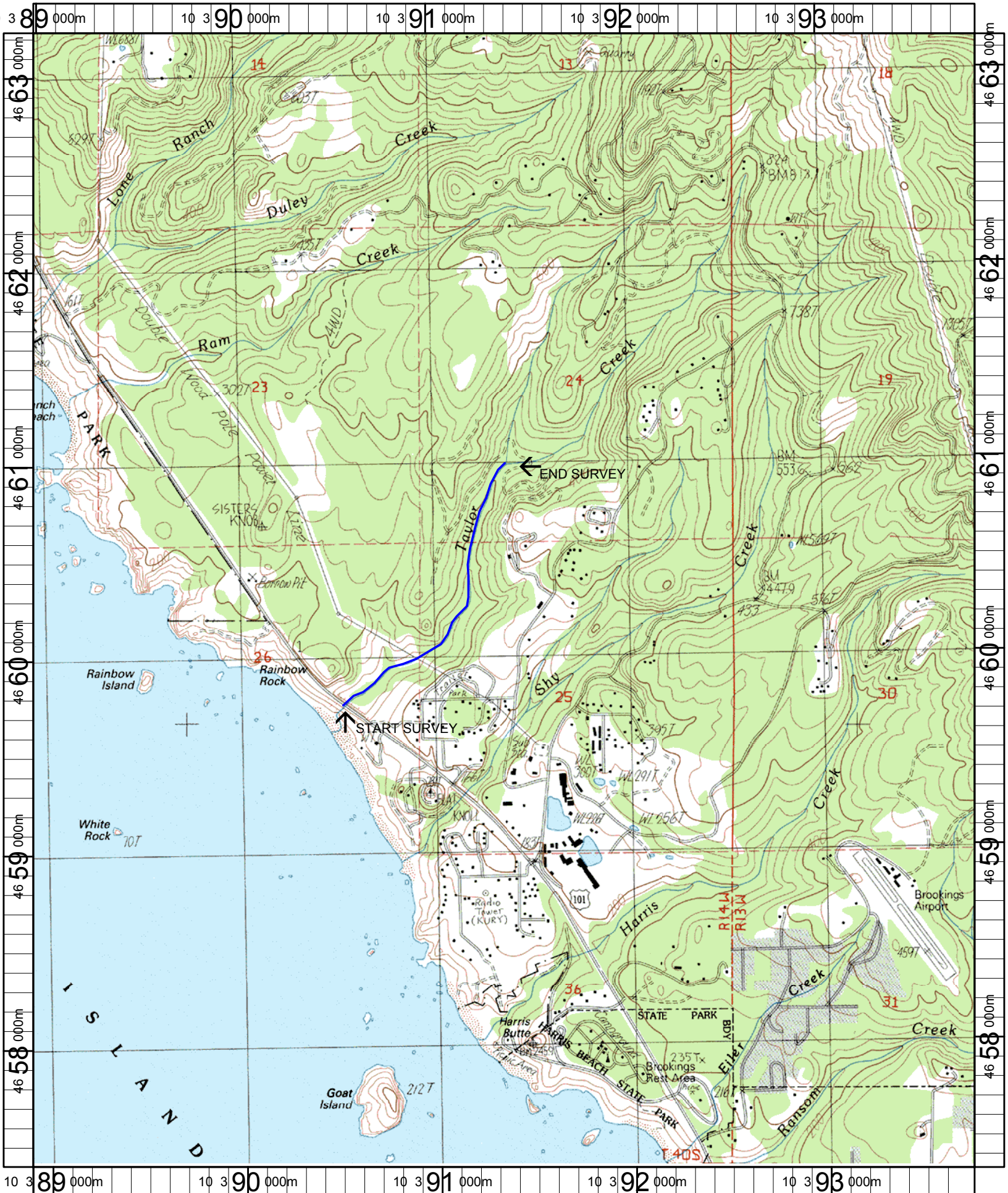

Name: BROOKINGS
 Date: 1/6/2005
 Scale: 1 inch equals 2000 feet

Location: 10 391360 E 4660282 N
 Caption: TAYLOR CREEK RESTORATION SITE - OCEAN BASIN