

ODFW AQUATIC INVENTORY PROJECT
OREGON PLAN FOR SALMON & WATERSHEDS
STREAM RESTORATION HABITAT REPORT

STREAM: Taylor Creek (S-274)
BASIN: Pacific Ocean
SURVEY TYPE: Pre-Tx
DATE: June 13, 2005
SURVEY CREW: Justin Gerding, Greg Ryder
REPORT PREPARED BY: Paul Jacobsen
BASIN AREA: 4.6 km²
USGS MAPS: Brookings
ECOREGION: Southern Oregon Coastal Mountains

GENERAL DESCRIPTION:

The Taylor Creek habitat survey extended 2,025 meters. The channel was constrained by hillslopes in a moderate V-shaped valley. The average valley width index was 5.3 (range: 1.0-20.0). Land use for the reach was young (3-15 cm dbh) and second growth (15-30 cm dbh) trees. The average unit gradient was 3.1 percent. Riffles (73%) dominated stream habitat. Sand (29%), gravel (27%) and cobble (25%) dominated stream substrate. Wood volume was very low at 7.3 m³/100m.

COMMENTS:

There was one potential barrier to upstream fish migration in the surveyed length. This was a 1.6 m high step over log at unit 45 (790 m).

REACH 1

T04S-R14W-S26NE

REACH 1

Valley and Channel Summary

Valley Characteristics (Percent Reach Length)

<u>Narrow Valley Floor</u>		<u>Broad Valley Floor</u>	
Steep V-shape	0%	Constraining Terraces	0%
Moderate V-shape	100%	Multiple Terraces	0%
Open V-shape	0%	Wide Floodplain	0%
Valley Width Index	5.3	VWI Range:	1 - 20

Channel Morphology (Percent Reach Length)

<u>Constrained</u>		<u>Unconstrained</u>	
Hillslope	100%	Single Channel	0%
Bedrock	0%	Multiple Channel	0%
Terrace	0%	Braided Channel	0%
Alt. Terrace/Hill	0%		
Landuse	0%		

Channel Characteristics

<u>Type</u>	<u>Length (m)</u>	<u>Area (m²)</u>	<u>Dry Units</u>
Primary Channel	2,025	6,349	0
Secondary Channel	21	23	0
Off-Channel Units	70	142	0

Channel Dimensions (m)

<u>Wetted</u>	<u>Active</u>	<u>Floodprone</u> n = 5	<u>First Terrace</u> n = 2
Width: 3.3	Width: 4.8	7.9 (5 - 10.8)	9.0 (5.5 - 12.5)
Depth: 0.34	Height: 0.4	0.9 (0.8 - 1)	1.1 (1.1 - 1.1)

W:D ratio: 11.0
 Stream Flow Type: LF
 Average Unit Gradient: 3.1%
 Water temperature (°C): 13.0 - 14.0
 Entrenchment (ACW:FPW ratio): 1.7
 Habitat Units/100m (total channel length): 4.5
 Habitat Units/100m (primary channel length): 4.7

Riparian, Bank, and Wood Summary

	<u>Primary</u>	<u>Secondary</u>
Land Use:	YT	ST
Riparian Vegetation:	D15	S

Bank Condition and Shade

<u>Bank Status</u>	<u>Percent Reach Length</u>	<u>Shade (% of 180)</u>
Actively Eroding:	0%	Reach avg: 91%
Undercut Banks:	1%	Range: 11 - 100

Large Wood Debris

	<u>Total</u>	<u>Total / 100m primary channel</u>
All pieces (>=3m x 0.15m):	245	12.1
Volume (m ³):	148	7.3
Key pieces (>=12m x 0.60m):	4	0.2

OREGON DEPT OF FISH AND WILDLIFE

TAYLOR CREEK PRE-TX (5-SC, 274)

HABITAT INVENTORY

Report Date: 4/26/2006

Survey Date:

6/13/2005

REACH 1		T04S-R14W-S26NE					REACH 1					
HABITAT DETAIL												
Habitat Type	Number Units	Total Length (m)	Avg Width (m)	Avg Depth (m)	Total Area (m ²)	Large Boulders (#>0.5m)	Substrate Percent Wetted Area					
							S/O	Snd	Grvl	Cbl	Bldr	Bdrk
CASCADE/BOULDERS	1	9	1.5	0.20	14	9	0	10	20	35	35	0
CULVERT CROSSING	1	105	1.8	0.15	189	0	0	0	5	5	0	90
POOL-BACKWATER	6	40	2.7	0.56	101	3	18	48	16	16	2	1
POOL-DAMMED	1	24	4.2	1.00	102	2	10	20	40	15	15	0
POOL-LATERAL SCOUR	19	206	4.0	0.74	814	14	10	38	23	21	5	3
POOL-PLUNGE	7	48	5.5	0.83	268	8	9	37	21	21	11	1
RAPID/BOULDERS	4	86	2.6	0.19	205	34	1	15	31	34	15	4
RIFFLE	45	1,583	3.0	0.14	4,774	166	2	25	34	30	7	2
STEP/BOULDERS	2	1	1.3	0.08	2	5	0	8	10	10	72	0
STEP/COBBLE	1	4	4.5	0.10	17	0	0	20	15	45	5	15
STEP/LOG	5	4	3.4	0.05	16	0	5	43	18	17	16	1
STEP/STRUCTURE	3	5	2.9	0.07	11	4	2	10	7	7	42	33
Total:	95	2,116	3.3	0.34	6,514	245	Avg: 5	29	27	25	10	4

HABITAT SUMMARY									
Habitat Group	Number Units	Total Length (m)	Avg Width (m)	Avg Depth (m)	Wetted Area		Large Boulders		
					(m ²)	Percent	Number	(# / 100m ²)	
Dammed & BW Pools	7	64	2.9	0.62	204	3.13%	5	2.5	
Scour Pools	26	254	4.4	0.76	1,082	16.61%	22	2.0	
Glides	0	0			0	0.00%	0	0.0	
Riffles	45	1,583	3.0	0.14	4,774	73.29%	166	3.5	
Rapids	4	86	2.6	0.19	205	3.15%	34	16.6	
Cascades	1	9	1.5	0.20	14	0.22%	9	63.8	
Step/Falls	11	14	3.0	0.06	46	0.70%	9	19.8	
Dry	0	0			0	0.00%	0	0.0	
Culverts	1	105	1.8	0.15	189	2.90%	0	0.0	

POOL SUMMARY			
	<u>Total</u>	Total of all Channel Lengths	Primary Channel Length
		<u># / Km</u>	<u># / Km</u>
All Pools:	33	15.6	16.3
Pools >=1m deep:	5	2.4	2.5
Complex pools (LWD pieces>=3):	6	2.8	3.0
Pool frequency (channel widths/pool):	13.4		
Residual pool depth (avg):	0.66		

OREGON DEPARTMENT OF FISH AND WILDLIFE
HABITAT INVENTORY

TAYLOR CREEK PRE-TX
GCG: 5-SC SITE ID: 274

Survey Date 6/13/2005
Report Date: 4/26/2006

**RIPARIAN ZONE
VEGETATION SUMMARY**

REACH 1

Summary of Riparian Zone (0-30m) 3 transects

Total hardwoods/1000	711
Total conifers/1000 ft	122
Total conifers >20" dbh/1000 ft	41
Total conifers >35" dbh/1000 ft	20

Average number of trees in a 5-meter wide band

Diameter class (cm)	Zone 1 0-10 meters		Zone 2 10 - 20 meters		Zone 3 20 - 30 meters		Zones 1-3 0-30 meters	
	Conifer	Hardwood	Conifer	Hardwood	Conifer	Hardwood	Conifer	Hardwood
3-15cm	0.3	0.0	1.0	1.7	0.0	1.7	1.3	3.3
15-30cm	0.0	1.0	0.0	1.3	0.0	1.0	0.0	3.3
30-50cm	0.0	1.7	0.0	1.7	0.0	1.7	0.0	5.0
50-90cm	0.0	0.0	0.0	0.0	0.3	0.0	0.3	0.0
>90cm	0.0	0.0	0.0	0.0	0.3	0.0	0.3	0.0
Total/100m2	0.3	2.7	1.0	4.7	0.7	4.3	0.7	3.9

Canopy closure and ground cover

	Zone 1 0-10 meters (%)	Zone 2 10 - 20 meters (%)	Zone 3 20 - 30 meters (%)
Canopy closure	70	63	73
Shrub cover	27	28	20
Grass/forb cover	73	72	78

Predominant landform in each zone

	Zone 1 0-10 meters (%)	Zone 2 10 - 20 meters (%)	Zone 3 20 - 30 meters (%)
Hillslope	83	83	83
High terrace	17	17	17
Low terrace	0	0	0
Floodplain	0	0	0
Wetland/meadow	0	0	0
Stream channel	0	0	0
Roadbed/Railroad	0	0	0
Riprap	0	0	0
Surface slope (%)	58	51	43

Summary of Riparian Zone (0-30m) for all reaches**3 transects****Summary of riparian zone (0-100 feet) extrapolated to 1,000 feet along stream**

Total hardwoods/1000	711
Total conifers/1000 ft	122
Total conifers >20" dbh/1000 ft	41
Total conifers >35" dbh/1000 ft	20

Average number of trees in a 5-m wide band

Diameter class (cm)	Zones 1-3	
	<u>0-30 meters</u>	
	<u>Conifer</u>	<u>Hardwood</u>
3-15cm	1.3	3.3
15-30cm	0.0	3.3
30-50cm	0.0	5.0
50-90cm	0.3	0.0
>90cm	0.3	0.0

RIPARIAN ZONE VEGETATION

Reach 1

Reach 1

Unit	Side	Zone	Surface	Slope	Cover (percent)				Diameter class (cm)					Notes	
					Canopy	Shrub	Grass		3-15	15-30	30-50	50-90	>90		
23	LF	1	HT	0	100	40	60	Conifer	1						
								Hardwood							
23	RT	3	HS	60	80	40	50	Conifer						1	
								Hardwood							
23	RT	2	HS	65	40	40	60	Conifer	1						
								Hardwood							
23	RT	1	HS	75	60	50	50	Conifer							
								Hardwood		2	2				
23	LF	3	HT	0	80	20	80	Conifer							
								Hardwood	1	1					
23	LF	2	HT	0	100	40	60	Conifer	2						INCLUDES A TRIB FROM U 22
								Hardwood							
55	LF	1	HS	50	100	0	100	Conifer							
								Hardwood							
55	RT	3	HS	65	40	20	80	Conifer					1		
								Hardwood			1				
55	RT	2	HS	80	40	40	60	Conifer							
								Hardwood		2	3				
55	RT	1	HS	80	80	40	60	Conifer							
								Hardwood							
55	LF	2	HS	30	100	10	90	Conifer							
								Hardwood	2						
55	LF	3	HS	30	80	20	80	Conifer							
								Hardwood	4	2					
66	RT	3	HS	30	80	20	80	Conifer							
								Hardwood				3			
66	LF	3	HS	70	80	0	100	Conifer							
								Hardwood				1			
66	LF	2	HS	90	60	20	80	Conifer							
								Hardwood							
66	LF	1	HS	100	20	20	80	Conifer							
								Hardwood			1	1			
66	RT	2	HS	40	40	20	80	Conifer							
								Hardwood	3	2	2				
66	RT	1	HS	40	60	10	90	Conifer							
								Hardwood				2			

Comment Summary

Restoration Monitoring Sites 2005

MONITORING AREA: **5-SC** SITE ID: **274** TAYLOR CREEK PRE-TX

UNIT#	TYPE	CHAN	DIST. (m)	COMMENTS	NOTE ESTIMATOR	NOTE NUMERATOR
1	CB	00	9.4		START AT BASE OF CB	T = 13 C AT 0925
3	SB	00	15.4		H = 1.2 M	
5	SS	00	23.4		H = .8 M	BEDROCK = CONCRETE
6	CC	00	128.2	CC	CONCRETE TUNNEL UND	CONCRETE TUNNEL UNDER
7	RB	00	139		U 6 = DIAM 1.8 M	
8	LP	00	144.7		TROUT FRY	TROUT FRY
15	RI	00	290.1			TROUT FRY
18	LP	00	336.5			TROUT
20	LP	00	371.8			CUTTHROAT TROUT, DEPTH
21	RI	01	407.1		TJ/	
22	RI	11	407.1		TRIB ACH = .3 M, ACW = 2	
23	LP	00	417.6	TJ/		
26	SL	00	438.1		H = .7 M	
32	RI	00	564.6	/SS		TROUT FRY
36	RI	00	644.1		TROUT FRY	TROUT FRY
40	PP	00	718.2			TROUT
41	SL	00	719.7		H = .7 M	
42	RI	00	769.7			TROUT FRY
45	SL	00	789.9	PN	H = 1.6 M	
46	RI	01	803.2	/SS		TROUT FRY
48	SS	00	805.1		H = .9 M	H = .9 M

Comment Summary

Restoration Monitoring Sites 2005

MONITORING AREA: 5-SC SITE ID: 274 TAYLOR CREEK PRE-TX

UNIT#	TYPE	CHAN	DIST. (m)	COMMENTS	NOTE ESTIMATOR	NOTE NUMERATOR
49	DP	00	829.5		CUTTHROAT	TROUT, TROUT FRY
51	PP	00	844.9	DJ		
52	SL	00	845.5		H = .9 M	
53	LP	00	861.1	FC		CUTTHROAT TROUT
57	RI	01	1008.8	DJ		
60	SB	00	1025.3		H = .6 M	
64	LP	01	1094.7	DJ		
66	RI	01	1194.7	/TJ		
69	SS	00	1229.6		OLD DAM, FILLED W/ SED	OLD DAM FILLED WITH SEDI
70	RI	00	1254.8	/CS		
71	LP	00	1263.8	SS/		
72	RI	00	1313.8	/SS		
75	SL	00	1341.85		H = .25 M	
83	RI	00	1686.55	DJ		
84	RI	00	1713.85			TROUT FRY
85	LP	00	1719.85			TROUT
92	RI	00	1939.05			TROUT FRY
94	LP	00	2006.05			CUTTHROAT TROUT

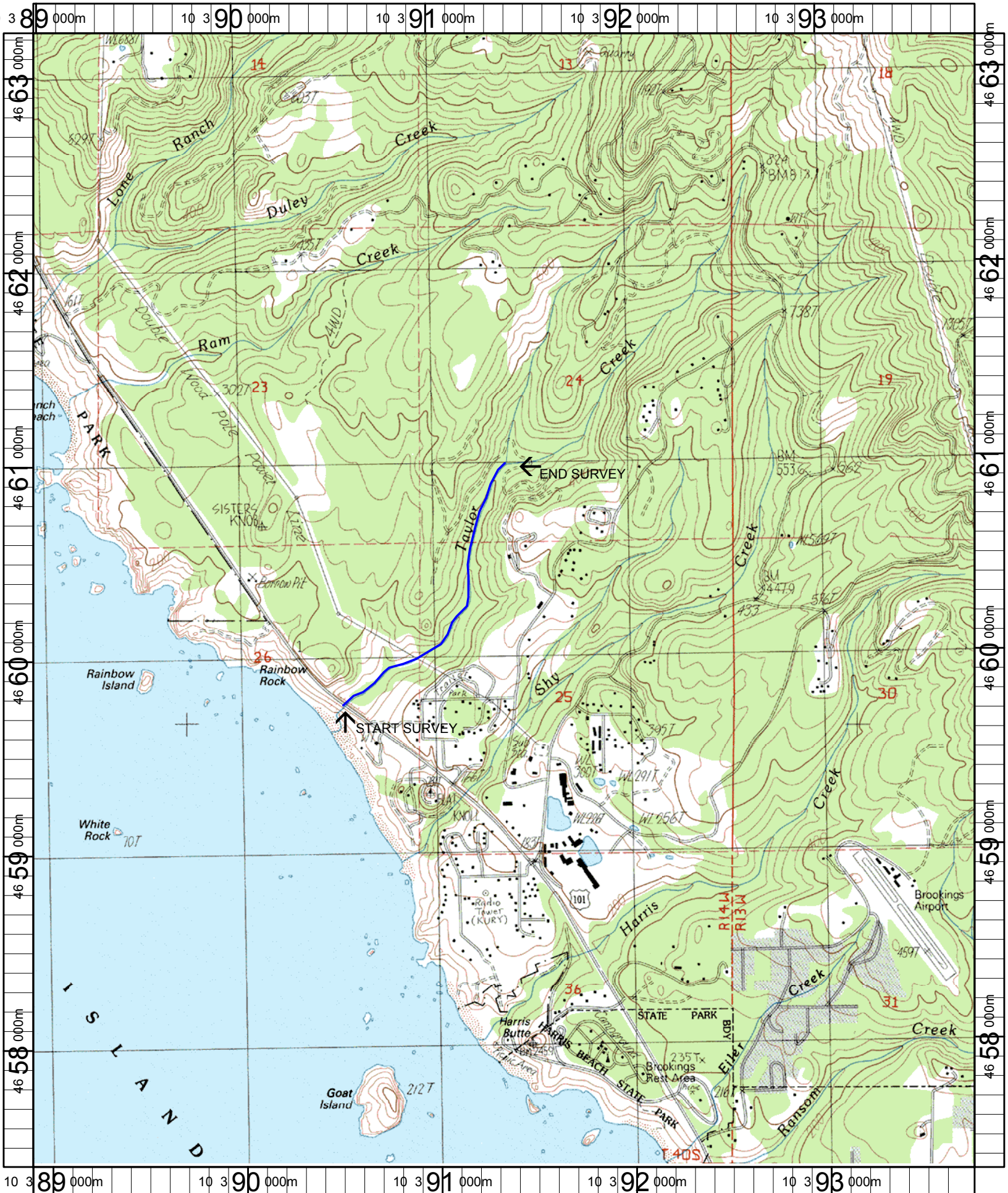

Name: BROOKINGS
 Date: 1/6/2005
 Scale: 1 inch equals 2000 feet

Location: 10 391360 E 4660282 N
 Caption: TAYLOR CREEK RESTORATION SITE - OCEAN BASIN