

REACH 1

T36S-R14W-S5SW

REACH 1

**Valley and Channel Summary**

Valley Characteristics (Percent Reach Length)

<u>Narrow Valley Floor</u>		<u>Broad Valley Floor</u>	
Steep V-shape	0%	Constraining Terraces	100%
Moderate V-shape	0%	Multiple Terraces	0%
Open V-shape	0%	Wide Floodplain	0%
Valley Width Index	11.6	VWI Range:	7 - 15

Channel Morphology (Percent Reach Length)

<u>Constrained</u>		<u>Unconstrained</u>	
Hillslope	0%	Single Channel	0%
Bedrock	0%	Multiple Channel	0%
Terrace	0%	Braided Channel	0%
Alt. Terrace/Hill	100%		
Landuse	0%		

Channel Characteristics

<u>Type</u>	<u>Length (m)</u>	<u>Area (m2)</u>	<u>Dry Units</u>
Primary	515	981	0
Secondary			0

Channel Dimensions (m)

<u>Wetted</u>		<u>Active</u>		<u>Floodprone</u>	<u>First Terrace</u>
Width	1.9	Width	4.6	5.7	8.5
Depth	0.35	Height	0.4	0.8	2.0
		W:D ratio	11.2	Entrenchment	1.2
Stream Flow Type:	LF	Water temp (C):		15.0 - 15.0	
Avg. Unit Gradient:	1.5%	Habitat Units/100m:		8.0	

**Riparian, Bank, and Wood Summary**

	<u>Primary</u>	<u>Secondary</u>
Land Use:	EX	AG
Riparian Vegetation:	D	S

Bank Condition and Shade

<u>Bank Status</u>	<u>Percent Reach Length</u>	<u>Shade (% of 180)</u>
Actively Eroding:	4%	Reach avg: 72%
Undercut Banks:	14%	Range: 22 - 100

Large Wood Debris

	<u>Total</u>	<u>Total / 100m</u>
All pieces (>=3m x 0.15m):	11	2.1
Volume (m <sup>3</sup> ):	8	1.5
Key pieces (>=10m x 0.60m):	0	0.0

OREGON DEPARTMENT OF FISH AND WILDLIFE

EDSON CREEK UPPER PRE-TX (SC-170)

HABITAT INVENTORY

Report Date: 3/17/03

Survey Date:

7/2/02

REACH 1		T36S-R14W-S5SW					REACH 1					
Habitat Type	Number Units	Total Length (m)	Avg Width (m)	Avg Depth (m)	Total Area (m <sup>2</sup> )	Large Boulders (#>0.5m)	Substrate					
							Percent Wetted Area					
							S/O	Snd	Grvl	Cbl	Bldr	Bdrk
CULVERT CROSSING	1	5	0.3	0.10	1	0	0	0	0	0	100	0
GLIDE	2	27	2.2	0.13	57	0	8	50	40	3	0	0
POOL-LATERAL SCOUR	20	268	2.3	0.54	611	67	17	32	41	6	4	0
POOL-PLUNGE	1	7	3.1	0.90	20	3	0	5	47	16	32	0
RIFFLE	13	198	1.4	0.17	273	26	9	20	59	8	3	0
STEP/BOULDERS	1	3	0.6	0.20	2	23	15	10	10	5	60	0
STEP/COBBLE	2	8	2.2	0.08	16	0	3	5	65	28	0	0
STEP/STRUCTURE	1	0	0.3	0.10	0	0	0	5	47	16	32	0
<b>Total:</b>	<b>41</b>	<b>515</b>	<b>1.9</b>	<b>0.35</b>	<b>981</b>	<b>119</b>	<b>Avg 12</b>	<b>25</b>	<b>47</b>	<b>8</b>	<b>8</b>	<b>0</b>

HABITAT SUMMARY								
Habitat Group	Number Units	Total Length (m)	Avg Width (m)	Avg Depth (m)	Wetted Area		Large Boulders	
					(m <sup>2</sup> )	Percent	Number	(# / 100m <sup>2</sup> )
Dammed & BW Pools	0	0			0	0.00%	0	0.0
Scour Pools	21	275	2.4	0.55	631	64.29%	70	11.1
Glides	2	27	2.2	0.13	57	5.85%	0	0.0
Riffles	13	198	1.4	0.17	273	27.83%	26	9.5
Rapids	0	0			0	0.00%	0	0.0
Cascades	0	0			0	0.00%	0	0.0
Step/Falls	4	11	1.3	0.11	19	1.89%	23	124.1
Dry	0	0			0	0.00%	0	0.0
Culverts	1	5	0.3	0.10	1	0.14%	0	0.0

POOL SUMMARY		
	<u>Total</u>	<u># / Km</u>
All Pools:	21	40.7
Pools >=1m deep:	0	0.0
Complex pools (LWD pieces>=3):	0	0.0
Pool frequency (channel widths/pool):	5.4	
Residual pool depth (avg):	0.48	

**RIPARIAN ZONE VEGETATION SUMMARY**

**REACH 1** **REACH 1**

**Summary of Riparian Zone (0-30m) 3 transects**

Total hardwoods/1000	305
Total conifers/1000 ft	20
Total conifers >20" dbh/1000 ft	0
Total conifers >35" dbh/1000 ft	0

**Average number of trees in a 5-meter wide band**

Diameter class (cm)	Zone 1 0-10 meters		Zone 2 10 - 20 meters		Zone 3 20 - 30 meters		Zones 1-3 0-30 meters	
	Conifer	Hardwood	Conifer	Hardwood	Conifer	Hardwood	Conifer	Hardwood
3-15cm	0.0	2.7	0.0	0.0	0.3	0.0	0.3	2.7
15-30cm	0.0	1.0	0.0	0.0	0.0	0.0	0.0	1.0
30-50cm	0.0	1.3	0.0	0.0	0.0	0.0	0.0	1.3
50-90cm	0.0	0.0	0.0	0.0	0.0	0.0	0.0	0.0
>90cm	0.0	0.0	0.0	0.0	0.0	0.0	0.0	0.0
Total/100m2	0.0	5.0	0.0	0.0	0.3	0.0	0.1	1.7

**Canopy closure and ground cover**

	Zone 1 0-10 meters (%)	Zone 2 10 - 20 meters (%)	Zone 3 20 - 30 meters (%)
Canopy closure	33	8	5
Shrub cover	24	8	8
Grass/forb cover	76	93	92

**Predominant landform in each zone**

	Zone 1 0-10 meters (%)	Zone 2 10 - 20 meters (%)	Zone 3 20 - 30 meters (%)
Hillslope	33	50	67
High terrace	67	50	33
Low terrace	0	0	0
Floodplain	0	0	0
Wetland/meadow	0	0	0
Stream channel	0	0	0
Roadbed/Railroad	0	0	0
Riprap	0	0	0
Surface slope (%)	10	12	24

**RIPARIAN ZONE VEGETATION**

Reach 1

Reach 1

Unit	Side	Zone	Surface	Slope	Cover (percent)				Diameter class (cm)					Notes
					Canopy	Shrub	Grass		3-15	15-30	30-50	50-90	>90	
11	LF	1	HS	30	50	15	85	Conifer						YEARLING TREES, RARRFD OLD ROAD BED
								Hardwood	3	1	2			
11	LF	2	HS	15	0	0	100	Conifer						
								Hardwood						
11	LF	3	HS	25	0	0	100	Conifer	1					
								Hardwood						
11	RT	1	HT	0	70	30	70	Conifer						
								Hardwood			2			
11	RT	2	HT	0	20	15	85	Conifer						
								Hardwood						
11	RT	3	HT	0	0	0	100	Conifer						
								Hardwood						
23	LF	1	HS	30	5	5	95	Conifer						
								Hardwood	4					
23	LF	2	HS	30	0	0	100	Conifer						
								Hardwood						
23	LF	3	HS	35	5	15	85	Conifer						RANCH ROAD
								Hardwood						
23	RT	1	HT	0	30	60	40	Conifer						
								Hardwood	1					
23	RT	2	HT	0	5	5	95	Conifer						FENCELINE
								Hardwood						
23	RT	3	HT	0	0	0	100	Conifer						PASTURE
								Hardwood						
31	LF	1	HT	0	25	15	85	Conifer						
								Hardwood			2			
31	LF	2	HT	0	0	0	100	Conifer						FENCELINE
								Hardwood						
31	LF	3	HS	55	0	0	100	Conifer						GRAVEL DRIVEWAY TO CHAIRRY
								Hardwood						
31	RT	1	HT	0	15	20	80	Conifer						
								Hardwood						
31	RT	2	HS	25	25	25	75	Conifer						
								Hardwood						
31	RT	3	HS	30	25	35	65	Conifer						
								Hardwood						

# Comment Summary

## Oregon Plan Monitoring Sites 2002

MONITORING AREA: **5-SC**      SITE ID: **170**      **EDSON CREEK UPPER PRE-TX (SC-1)**

<u>UNIT#</u>	<u>TYPE</u>	<u>CHAN</u>	<u>DIST. (m)</u>	<u>COMMENTS</u>	<u>NOTE ESTIMATOR</u>	<u>NOTE NUMERATOR</u>
1	RI	00	10.9			T = 15 @ 3:00
4	LP	00	42.8			BOULDER IS POSSIBLE RIPR
6	LP	00	64.9			BOULDER RIPRAP
8	LP	00	100.9	SS/		BOULDER RIPRAP
9	SC	00	104.1		H = .5	
10	LP	00	131.7			3" LARGE FISH IN POOL
11	RI	00	149.8			RIPARIAN #1
12	LP	00	158.1			RIPRAP
13	SC	00	162.4		H = .3	
15	LP	00	193.8	DJ, /LI		SMALL WOOD DJ, /BANK FAL
16	LP	00	205			RIPRAP BOULDERS
18	LP	00	226	/LS		
19	RI	00	243.1	/LS		FISH, MONKEY FLOWERS
20	SB	00	246.5	/LS	H = .4	ROCKS PUT IN TO BUILD UP
22	SS	00	253.3		H = .7	H = .7
23	CC	00	257.8	CC	1M DIA CORR. UNDER RA	1.0M x 1.5M
25	LP	00	277.2			RIPRAP
33	GL	00	396.6			FISH
37	LP	00	454.4			RIPRAP
39	LP	00	477.3			RIPRAP



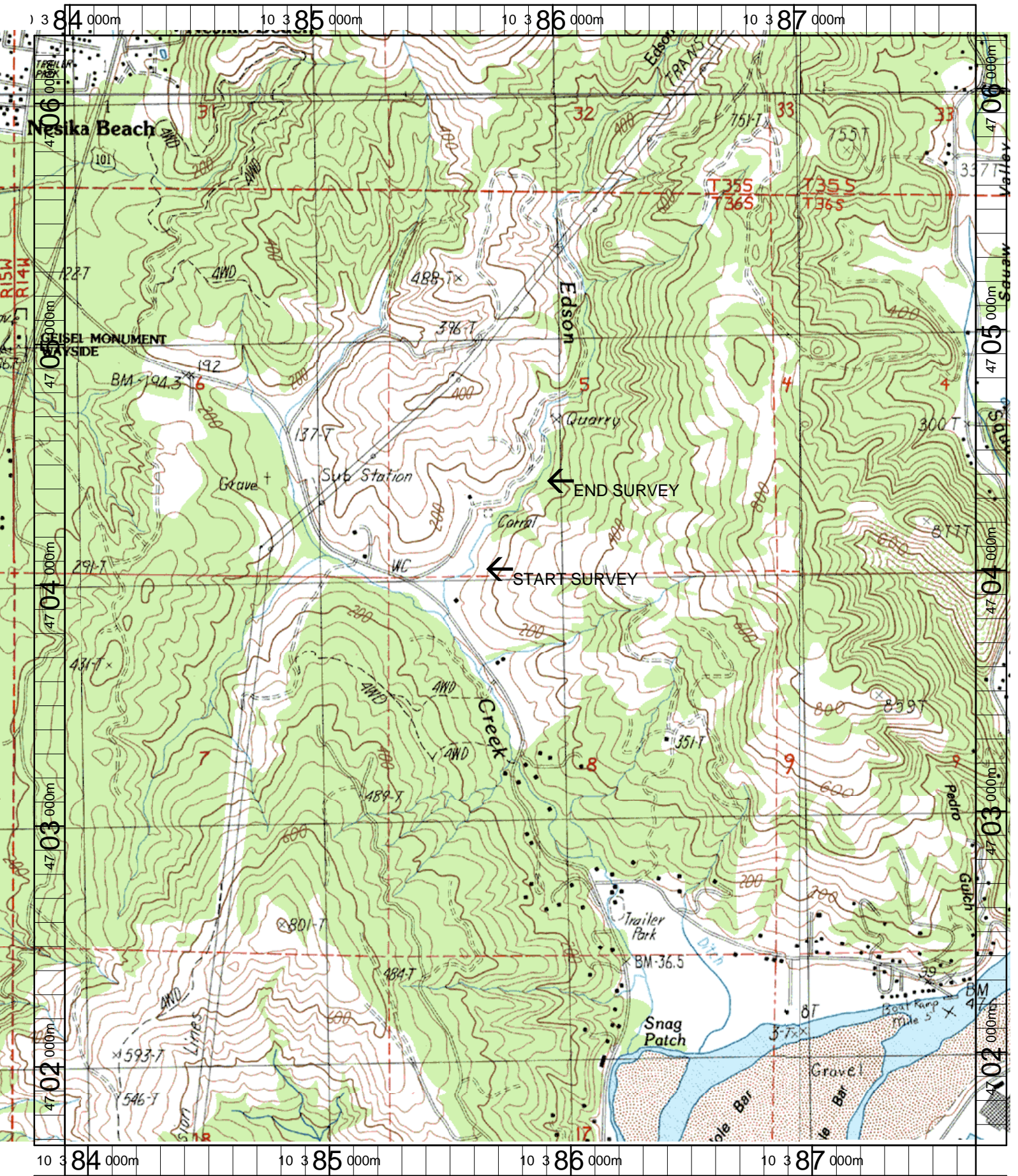

Name: GOLD BEACH  
 Date: 3/21/2003  
 Scale: 1 inch equals 1666 feet

Location: 10 385824 E 4703952 N  
 Caption: EDSON CREEK UPPER RESTORATION SITE - ROGUE BASIN