

REACH

T32S-R15W-S17SW

REACH

Valley and Channel Summary

Valley Characteristics (Percent Reach Length)

<u>Narrow Valley Floor</u>		<u>Broad Valley Floor</u>	
Steep V-shape	0%	Constraining Terraces	0%
Moderate V-shape	0%	Multiple Terraces	0%
Open V-shape	0%	Wide Floodplain	100%
Valley Width Index	85.8	VWI Range:	80 - 99

Channel Morphology (Percent Reach Length)

<u>Constrained</u>		<u>Unconstrained</u>	
Hillslope	0%	Single Channel	100%
Bedrock	0%	Multiple Channel	0%
Terrace	0%	Braided Channel	0%
Alt. Terrace/Hill	0%		
Landuse	0%		

Channel Characteristics

<u>Type</u>	<u>Length (m)</u>	<u>Area (m2)</u>	<u>Dry Units</u>
Primary	504	1,069	1
Secondary	197	2,756	0

Channel Dimensions (m)

<u>Wetted</u>		<u>Active</u>		<u>Floodprone</u>	<u>First Terrace</u>
Width	2.4	Width	4.0	36.1	23.1
Depth	0.38	Height	0.6	1.1	1.7
		W:D ratio	7.0	Entrenchment	10.7

Stream Flow Type:	MF	Water temp (C):	8.5 - 8.5
Avg. Unit Gradient:	0.4%	Habitat Units/100m:	6.1

Riparian, Bank, and Wood Summary

	<u>Primary</u>	<u>Secondary</u>
Land Use:	LG	ST
Riparian Vegetation:	D3	S

Bank Condition and Shade

<u>Bank Status</u>	<u>Percent Reach Length</u>	<u>Shade (% of 180)</u>
Actively Eroding:		Reach avg:
Undercut Banks:		Range: -

Large Wood Debris

	<u>Total</u>	<u>Total / 100m</u>
All pieces (>=3m x 0.15m):	3	0.6
Volume (m ³):	0	0.1
Key pieces (>=10m x 0.60m):	0	0.0

OREGON DEPARTMENT OF FISH AND WILDLIFE

CEDAR CREEK POST-TX (S-128)

HABITAT INVENTORY

Report Date: 5/6/03

Survey Date:

2/27/03

REACH		T32S-R15W-S17SW					REACH					
HABITAT DETAIL												
Habitat Type	Number Units	Total Length (m)	Avg Width (m)	Avg Depth (m)	Total Area (m ²)	Large Boulders (#>0.5m)	Substrate Percent Wetted Area					
							S/O	Snd	Grvl	Cbl	Bldr	Bdrk
GLIDE	10	384	3.9	0.42	3,278	0	39	51	10	0	0	0
POOL-LATERAL SCOUR	8	110	2.4	0.74	288	0	27	60	13	0	0	0
PUDDLED UNIT	1	17	0.7	0.02	12	0	30	60	10	0	0	0
RIFFLE	11	188	1.4	0.15	246	0	23	51	24	1	0	0
STEP/COBBLE	1	2	0.5	0.10	1	0	0	9	9	64	14	5
Total:	31	701	2.4	0.38	3,825	0	Avg 29	52	16	2	1	0

HABITAT SUMMARY									
Habitat Group	Number Units	Total Length (m)	Avg Width (m)	Avg Depth (m)	Wetted Area		Large Boulders		
					(m ²)	Percent	Number	(# / 100m ²)	
Dammed & BW Pools	0	0			0	0.00%	0	0.0	
Scour Pools	8	110	2.4	0.74	288	7.52%	0	0.0	
Glides	10	384	3.9	0.42	3,278	85.71%	0	0.0	
Riffles	11	188	1.4	0.15	246	6.43%	0	0.0	
Rapids	0	0			0	0.00%	0	0.0	
Cascades	0	0			0	0.00%	0	0.0	
Step/Falls	1	2	0.5	0.10	1	0.03%	0	0.0	
Dry	1	17	0.7	0.02	12	0.31%	0	0.0	
Culverts	0	0			0	0.00%	0	0.0	

POOL SUMMARY		
	Total	# / Km
All Pools:	8	15.9
Pools >=1m deep:	1	2.0
Complex pools (LWD pieces>=3):	0	0.0
Pool frequency (channel widths/pool):	21.7	
Residual pool depth (avg):	0.54	

STREAM SUMMARY

CEDAR CREEK POST-TX (S-128)

Number Units	Total Length (m)	Avg Width (m)	Avg Depth (m)	Total Area (m ²)	Substrate						Large Boulders (#>0.5m)
					Percent Wetted Area						
					S/O	Snd	Grvl	Cbl	Bldr	Bdrk	
31	701	2.4	0.38	3,825	29	52	16	2	1	0	

Habitat Group	Wetted Area	
	(m ²)	Percent
Dammed & BW Pools	0	0.00%
Scour Pools	288	7.52%
Glides	3,278	85.71%
Riffles	246	6.43%
Rapids	0	0.00%
Cascades	0	0.00%
Step/Falls	1	0.03%
Dry	12	0.31%
Culverts	0	0.00%

Comment Summary

Restoration Monitoring Sites 2003

MONITORING AREA: 5-SC SITE ID: 128 CEDAR CREEK POST-TX (S-128)

<u>UNIT#</u>	<u>TYPE</u>	<u>CHAN</u>	<u>DIST. (m)</u>	<u>COMMENTS</u>	<u>NOTE ESTIMATOR</u>	<u>NOTE NUMERATOR</u>
1	GL	00	25	BV		START SIGN/, STICKS
2	GL	00	43			BLACKBERRIES OBSCUR
3	LP	00	50			YT CON. PLANTED ALON
4	RI	00	70			SEDGES=U3
6	RI	00	90			SKUNK CABBAGE
7	LP	00	99.8			FENCE TO KEEP SHEEP
9	RI	00	149.8	WL		BIRDS, MALLARDS
10	RI	00	158.8			CLAY IN CR
13	RI	01	190.8	TJ/		
14	RI	11	190.8			T=11C, UNNAMED TRIB
15	SC	11	190.8			H=0.6M
16	LP	01	220.8	WL, TJ/		FROG, MADRONE/, DEAD
18	GL	01	245.8	WL		FROGS, SEDGES, GRASS
21	GL	00	293.8	SS/		
23	GL	00	328.8			FENCE ON HS/
24	RI	00	353.8			MADRONE 50CM+
25	RI	00	378.8	SS/		
28	LP	00	433.1			FISH
29	LP	00	454.1	SS/		FISH
31	GL	00	504.1			END @CC, T=10C

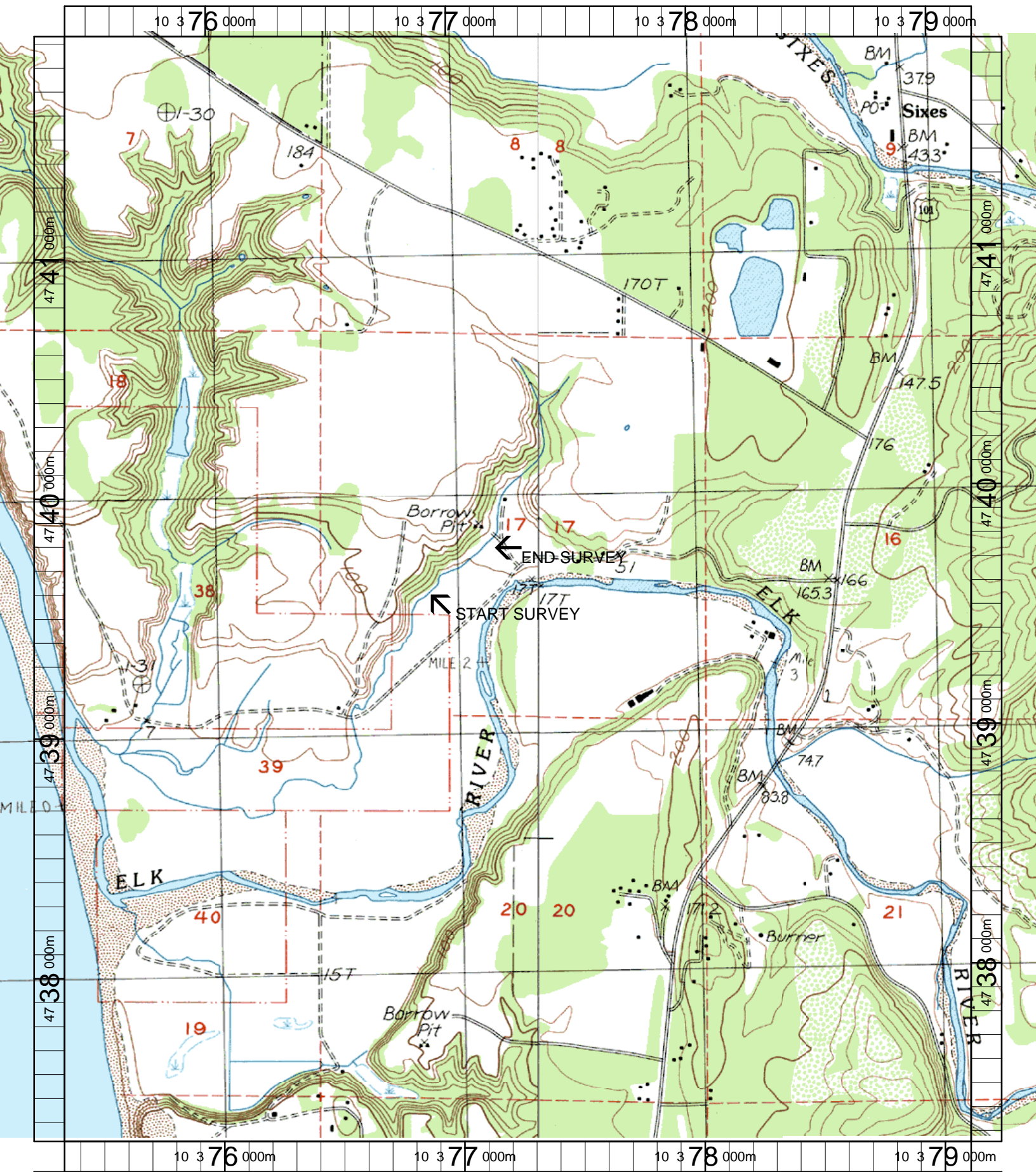

Name: CAPE BLANCO
 Date: 3/21/2003
 Scale: 1 inch equals 1666 feet

Location: 10 377256 E 4739596 N
 Caption: CEDAR CREEK RESTORATION SITE - ELK BASIN