

**ODFW AQUATIC INVENTORY PROJECT**  
**OREGON PLAN FOR SALMON & WATERSHEDS**  
**STREAM RESTORATION HABITAT REPORT**

STREAM: Cedar Creek (S-128)  
BASIN: Elk River  
SURVEY TYPE: Post-Tx  
DATE: July 15, 2003  
SURVEY CREW: Nate Davis, Lucas Lawrence  
REPORT PREPARED BY: Paul Jacobsen  
BASIN AREA: 3.2 km<sup>2</sup>  
USGS MAPS: Cape Blanco  
ECOREGION: Coast Range Sitka Spruce

**GENERAL DESCRIPTION:**

The Cedar Creek habitat survey extended 579 meters. The channel was unconstrained in a broad valley floor. The average valley width index was 20.0. Land use for the reach was heavy grazing and young (3-15 cm dbh) trees. The average unit gradient was 0.3 percent. Scour pools (85%) dominated stream habitat. Fines (43%) and sand (31%) dominated stream substrate. Wood volume was very low at 0.1 m<sup>3</sup>/100m.

**COMMENTS:**

There were no potential barriers to upstream fish migration in the surveyed length.

REACH 1

T32S-R15W-S17NW

REACH 1

**Valley and Channel Summary**

Valley Characteristics (Percent Reach Length)

<u>Narrow Valley Floor</u>		<u>Broad Valley Floor</u>	
Steep V-shape	0%	Constraining Terraces	0%
Moderate V-shape	0%	Multiple Terraces	0%
Open V-shape	0%	Wide Floodplain	100%
Valley Width Index	20.0	VWI Range:	20 - 20

Channel Morphology (Percent Reach Length)

<u>Constrained</u>		<u>Unconstrained</u>	
Hillslope	0%	Single Channel	100%
Bedrock	0%	Multiple Channel	0%
Terrace	0%	Braided Channel	0%
Alt. Terrace/Hill	0%		
Landuse	0%		

Channel Characteristics

<u>Type</u>	<u>Length (m)</u>	<u>Area (m2)</u>	<u>Dry Units</u>
Primary	579	2,224	0
Secondary	128	621	0

Channel Dimensions (m)

<u>Wetted</u>		<u>Active</u>		<u>Floodprone</u>	<u>First Terrace</u>
Width	3.0	Width	5.1	30.2	6.7
Depth	0.35	Height	0.4	0.8	1.2
		W:D ratio	18.0	Entrenchment	7.7
Stream Flow Type:	LF	Water temp (C):	-		
Avg. Unit Gradient:	0.3%	Habitat Units/100m:	4.0		

**Riparian, Bank, and Wood Summary**

	<u>Primary</u>	<u>Secondary</u>
Land Use:	HG	YT
Riparian Vegetation:	M3	G

Bank Condition and Shade

<u>Bank Status</u>	<u>Percent Reach Length</u>	<u>Shade (% of 180)</u>
Actively Eroding:	1%	Reach avg: 53%
Undercut Banks:	1%	Range: 14 - 100

Large Wood Debris

	<u>Total</u>	<u>Total / 100m</u>
All pieces (>=3m x 0.15m):	2	0.3
Volume (m <sup>3</sup> ):	0	0.1
Key pieces (>=10m x 0.60m):	0	0.0

OREGON DEPARTMENT OF FISH AND WILDLIFE

CEDAR CREEK POST-TX (S-128)

HABITAT INVENTORY

Report Date: 12/17/03

Survey Date:

7/15/03

REACH 1		T32S-R15W-S17NW					REACH 1					
HABITAT DETAIL												
Habitat Type	Number Units	Total Length (m)	Avg Width (m)	Avg Depth (m)	Total Area (m <sup>2</sup> )	Large Boulders (#>0.5m)	Substrate Percent Wetted Area					
							S/O	Snd	Grvl	Cbl	Bldr	Bdrk
POOL-LATERAL SCOUR	3	25	3.2	0.58	107	0	45	13	2	2	0	39
POOL-STRAIGHT SCOUR	11	528	4.1	0.53	2,315	0	57	31	0	0	0	12
RIFFLE	12	131	1.9	0.15	296	1	32	41	11	8	0	8
RIFFLE W/ POCKETS	1	20	6.1	0.20	124	0	30	0	0	0	0	70
STEP/BEDROCK	1	2	1.5	0.15	2	0	18	12	0	0	0	71
<b>Total:</b>	28	707	3.0	0.35	2,845	1	<b>Avg</b> 43	31	5	4	0	17

HABITAT SUMMARY										128
Habitat Group	Number Units	Total Length (m)	Avg Width (m)	Avg Depth (m)	Wetted Area		Large Boulders			
					(m <sup>2</sup> )	Percent	Number	(# / 100m <sup>2</sup> )		
Dammed & BW Pools	0	0			0	0.00%	0	0.0		
Scour Pools	14	554	3.9	0.54	2,422	85.14%	0	0.0		
Glides	0	0			0	0.00%	0	0.0		
Riffles	13	151	2.2	0.15	420	14.77%	1	0.2		
Rapids	0	0			0	0.00%	0	0.0		
Cascades	0	0			0	0.00%	0	0.0		
Step/Falls	1	2	1.5	0.15	2	0.08%	0	0.0		
Dry	0	0			0	0.00%	0	0.0		
Culverts	0	0			0	0.00%	0	0.0		

POOL SUMMARY		
	Total	# / Km
All Pools:	14	19.8
Pools >=1m deep:	1	1.4
Complex pools (LWD pieces>=3):	0	0.0
Pool frequency (channel widths/pool):	9.9	
Residual pool depth (avg):	0.41	

**STREAM SUMMARY**

**CEDAR CREEK POST-TX (S-128)**

Number Units	Total Length (m)	Avg Width (m)	Avg Depth (m)	Total Area (m <sup>2</sup> )	Substrate						Large Boulders (#>0.5m)
					Percent Wetted Area						
					S/O	Snd	Grvl	Cbl	Bldr	Bdrk	
28	707	3.0	0.35	2,845	43	31	5	4	0	17	1

Habitat Group	Wetted Area	
	(m <sup>2</sup> )	Percent
Dammed & BW Pools	0	0.00%
Scour Pools	2,422	85.14%
Glides	0	0.00%
Riffles	420	14.77%
Rapids	0	0.00%
Cascades	0	0.00%
Step/Falls	2	0.08%
Dry	0	0.00%
Culverts	0	0.00%

**RIPARIAN ZONE VEGETATION SUMMARY**

REACH 1	REACH 1
<b>Summary of Riparian Zone (0-30m) 3 transects</b>	
Total hardwoods/1000	345
Total conifers/1000 ft	61
Total conifers >20" dbh/1000 ft	41
Total conifers >35" dbh/1000 ft	41

**Average number of trees in a 5-meter wide band**

Diameter class (cm)	Zone 1 0-10 meters		Zone 2 10 - 20 meters		Zone 3 20 - 30 meters		Zones 1-3 0-30 meters	
	Conifer	Hardwood	Conifer	Hardwood	Conifer	Hardwood	Conifer	Hardwood
3-15cm	0.0	3.0	0.0	0.3	0.0	0.7	0.0	4.0
15-30cm	0.3	0.7	0.0	0.7	0.0	0.3	0.3	1.7
30-50cm	0.0	0.0	0.0	0.0	0.0	0.0	0.0	0.0
50-90cm	0.0	0.0	0.0	0.0	0.0	0.0	0.0	0.0
>90cm	0.3	0.0	0.3	0.0	0.0	0.0	0.7	0.0
Total/100m2	0.7	3.7	0.3	1.0	0.0	1.0	0.3	1.9

**Canopy closure and ground cover**

	Zone 1 0-10 meters	Zone 2 10 - 20 meters	Zone 3 20 - 30 meters
	(%)	(%)	(%)
Canopy closure	25	22	22
Shrub cover	37	17	28
Grass/forb cover	66	75	68

**Predominant landform in each zone**

	Zone 1 0-10 meters	Zone 2 10 - 20 meters	Zone 3 20 - 30 meters
	(%)	(%)	(%)
Hillslope	0	33	0
High terrace	17	17	50
Low terrace	0	0	17
Floodplain	83	50	33
Wetland/meadow	0	0	0
Stream channel	0	0	0
Roadbed/Railroad	0	0	0
Riprap	0	0	0
Surface slope (%)	2	20	0

---

Summary of Riparian Zone (0-30m) for all reaches                      3 transects

Summary of riparian zone (0-100 feet) extrapolated to 1,000 feet along stream

Total hardwoods/1000	345
Total conifers/1000 ft	61
Total conifers >20" dbh/1000 ft	41
Total conifers >35" dbh/1000 ft	41

**Average number of trees in a 5-m wide band**

Diameter class (cm)	Zones 1-3 <u>0-30 meters</u>	
	<u>Conifer</u>	<u>Hardwood</u>
3-15cm	0.0	4.0
15-30cm	0.3	1.7
30-50cm	0.0	0.0
50-90cm	0.0	0.0
>90cm	0.7	0.0

---

**RIPARIAN ZONE VEGETATION**

Reach 1

Reach 1

Unit	Side	Zone	Surface	Slope	Cover (percent)				Diameter class (cm)					Notes	
					Canopy	Shrub	Grass		3-15	15-30	30-50	50-90	>90		
9	LF	1	FP	0	30	20	20	Conifer							BW & VEG
								Hardwood	3	2					
9	LF	3	HT	0	20	70	30	Conifer							
								Hardwood							
9	RT	1	FP	0	0	100	100	Conifer			1				
								Hardwood							
9	RT	2	FP	0	0	0	100	Conifer							
								Hardwood							
9	RT	3	LT	0	0	0	100	Conifer							
								Hardwood							
9	LF	2	HS	60	40	40	60	Conifer							
								Hardwood			1				
13	LF	2	HS	60	20	40	60	Conifer							
								Hardwood	1	1					
13	LF	1	FP	0	10	80	15	Conifer							
								Hardwood	1						
13	LF	3	HT	0	40	40	20	Conifer							
								Hardwood	2	1					
13	RT	1	FP	0	0	0	100	Conifer							
								Hardwood							
13	RT	2	FP	0	0	0	100	Conifer							
								Hardwood							
13	RT	3	FP	0	0		100	Conifer							
								Hardwood							
18	RT	3	FP	0	0	0	100	Conifer							
								Hardwood							
18	RT	2	FP	0	0	0	100	Conifer							
								Hardwood							
18	RT	1	FP	0	15	10	80	Conifer							
								Hardwood	5						
18	LF	3	HT	0	70	30	60	Conifer							
								Hardwood							
18	LF	2	HT	0	70	20	30	Conifer							1
								Hardwood							
18	LF	1	HT	10	95	10	80	Conifer							1
								Hardwood							

# Comment Summary

## Oregon Plan Monitoring Sites 2003

MONITORING AREA: **5-SC**      SITE ID: **128**      CEDAR CREEK POST-TX (S-128)

<u>UNIT#</u>	<u>TYPE</u>	<u>CHAN</u>	<u>DIST. (m)</u>	<u>COMMENTS</u>	<u>NOTE ESTIMATOR</u>	<u>NOTE NUMERATOR</u>
2	RI	01	39.9	TJ/		
9	SP	00	193.8			10 CAR F SILTY MUD
11	RI	11	204	TJ/		
12	SP	00	289.2	SS/		
14	RI	01	368.3			BR=HP & CLAY
15	SP	01	399.29			BR= HP & CLAY
16	RP	01	419.69			BR= HP & CLAY
17	SP	01	448.99			BR= HP & CLAY
18	RI	01	469.99			BR= HP & CLAY
19	LP	01	482.49			BR= HP & CLAY
21	RI	00	487.49			BR= HP & CLAY
22	LP	00	493.89			BR= HP & CLAY
25	SR	00	505.49			BR= HP & CLAY
28	SP	00	578.89	CC		



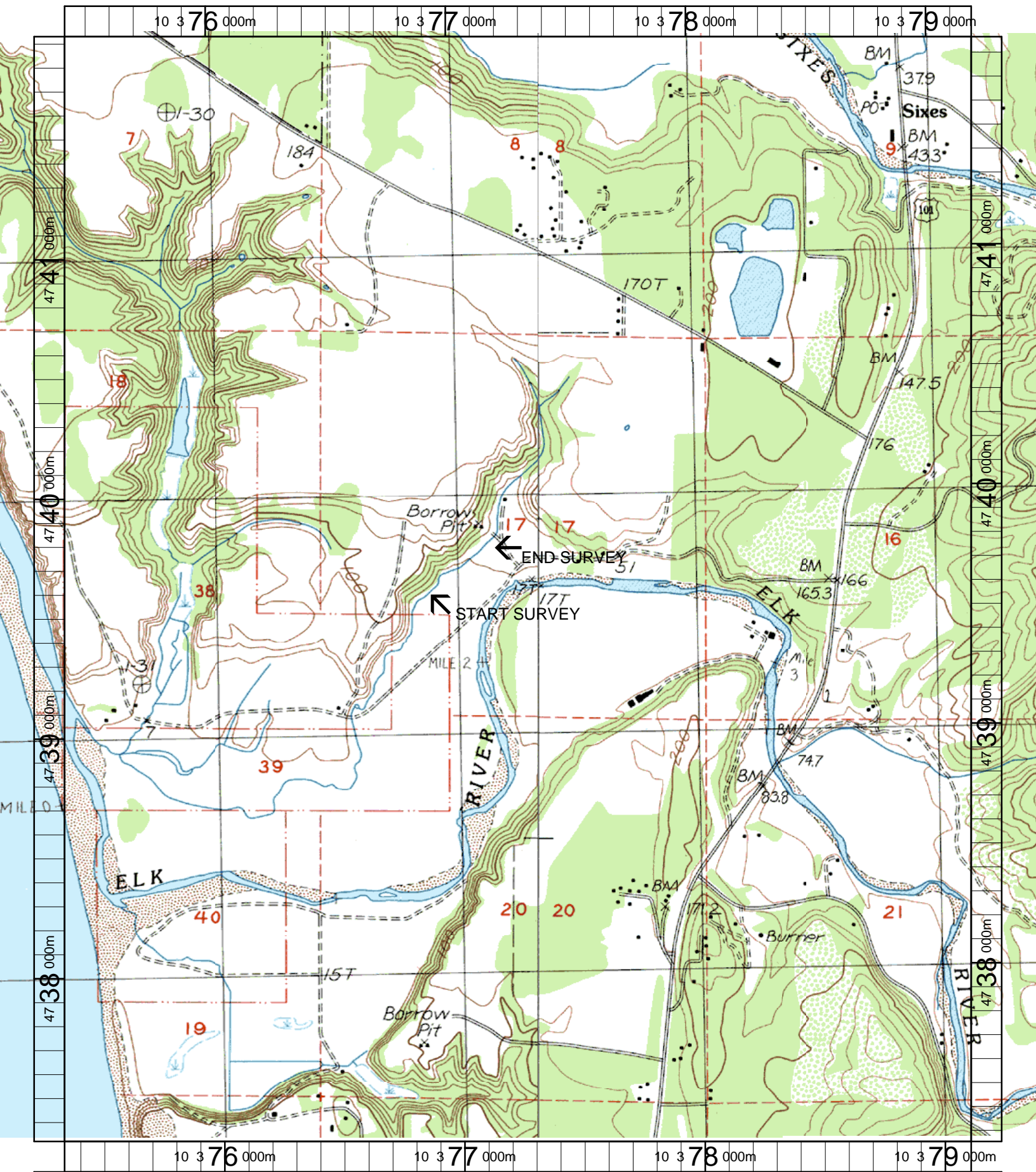

Name: CAPE BLANCO  
 Date: 3/21/2003  
 Scale: 1 inch equals 1666 feet

Location: 10 377256 E 4739596 N  
 Caption: CEDAR CREEK RESTORATION SITE - ELK BASIN