

REACH 1

T32S-R15W-S17SW

REACH 1

Valley and Channel Summary

Valley Characteristics (Percent Reach Length)

<u>Narrow Valley Floor</u>		<u>Broad Valley Floor</u>	
Steep V-shape	0%	Constraining Terraces	0%
Moderate V-shape	0%	Multiple Terraces	0%
Open V-shape	0%	Wide Floodplain	100%
Valley Width Index	20.0	VWI Range:	20 - 20

Channel Morphology (Percent Reach Length)

<u>Constrained</u>		<u>Unconstrained</u>	
Hillslope	0%	Single Channel	100%
Bedrock	0%	Multiple Channel	0%
Terrace	0%	Braided Channel	0%
Alt. Terrace/Hill	0%		
Landuse	0%		

Channel Characteristics

<u>Type</u>	<u>Length (m)</u>	<u>Area (m2)</u>	<u>Dry Units</u>
Primary	493	940	0
Secondary	26	23	0

Channel Dimensions (m)

<u>Wetted</u>		<u>Active</u>		<u>Floodprone</u>	<u>First Terrace</u>
Width	1.6	Width	4.2	85.9	
Depth	0.56	Height	0.6	1.2	
		W:D ratio	6.9	Entrenchment	20.5
Stream Flow Type:	LF			Water temp (C):	16.0 - 16.0
Avg. Unit Gradient:	0.1%			Habitat Units/100m:	6.3

Riparian, Bank, and Wood Summary

	<u>Primary</u>	<u>Secondary</u>
Land Use:	HG	YT
Riparian Vegetation:	M3	G

Bank Condition and Shade

<u>Bank Status</u>	<u>Percent Reach Length</u>	<u>Shade (% of 180)</u>
Actively Eroding:	0%	Reach avg: 67%
Undercut Banks:	73%	Range: 23 - 100

Large Wood Debris

	<u>Total</u>	<u>Total / 100m</u>
All pieces (>=3m x 0.15m):		
Volume (m ³):		
Key pieces (>=10m x 0.60m):		

OREGON DEPARTMENT OF FISH AND WILDLIFE

CEDAR CREEK PRE-TX (SC-128)

HABITAT INVENTORY

Report Date: 3/17/03

Survey Date:

7/3/02

REACH 1		T32S-R15W-S17SW					REACH 1						
HABITAT DETAIL													
Habitat Type	Number	Total	Avg	Avg	Total	Large	Substrate						
	Units	Length	Width	Depth	Area	Boulders	Percent Wetted Area						
		(m)	(m)	(m)	(m ²)	(>0.5m)	S/O	Snd	Grvl	Cbl	Bldr	Bdrk	
POOL-BACKWATER	2	11	1.3	0.33	13	0	43	58	0	0	0	0	
POOL-LATERAL SCOUR	19	447	2.0	0.63	892	0	35	54	11	0	0	0	
RIFFLE	10	62	0.9	0.48	58	0	26	50	24	0	0	0	
Total:	31	519	1.6	0.56	963	0	Avg 32	53	14	0	0	0	

HABITAT SUMMARY									
Habitat Group	Number	Total	Avg	Avg	Wetted Area		Large Boulders		
	Units	Length	Width	Depth	(m ²)	Percent	Number	(# / 100m ²)	
		(m)	(m)	(m)					
Dammed & BW Pools	2	11	1.3	0.33	13	1.35%	0	0.0	
Scour Pools	19	447	2.0	0.63	892	92.64%	0	0.0	
Glides	0	0			0	0.00%	0	0.0	
Riffles	10	62	0.9	0.48	58	6.01%	0	0.0	
Rapids	0	0			0	0.00%	0	0.0	
Cascades	0	0			0	0.00%	0	0.0	
Step/Falls	0	0			0	0.00%	0	0.0	
Dry	0	0			0	0.00%	0	0.0	
Culverts	0	0			0	0.00%	0	0.0	

POOL SUMMARY

	<u>Total</u>	<u># / Km</u>
All Pools:	21	42.6
Pools >=1m deep:	3	6.1
Complex pools (LWD pieces>=3):	0	0.0
Pool frequency (channel widths/pool):	5.9	
Residual pool depth (avg):	0.30	

RIPARIAN ZONE VEGETATION SUMMARY

REACH 1 **REACH 1**

Summary of Riparian Zone (0-30m) 3 transects

Total hardwoods/1000	691
Total conifers/1000 ft	264
Total conifers >20" dbh/1000 ft	41
Total conifers >35" dbh/1000 ft	0

Average number of trees in a 5-meter wide band

Diameter class (cm)	Zone 1		Zone 2		Zone 3		Zones 1-3	
	0-10 meters		10 - 20 meters		20 - 30 meters		0-30 meters	
	Conifer	Hardwood	Conifer	Hardwood	Conifer	Hardwood	Conifer	Hardwood
3-15cm	1.0	3.7	1.7	1.0	0.3	2.7	3.0	7.3
15-30cm	0.0	0.0	0.0	1.3	0.3	2.7	0.3	4.0
30-50cm	0.0	0.0	0.0	0.0	0.3	0.0	0.3	0.0
50-90cm	0.0	0.0	0.0	0.0	0.7	0.0	0.7	0.0
>90cm	0.0	0.0	0.0	0.0	0.0	0.0	0.0	0.0
Total/100m2	1.0	3.7	1.7	2.3	1.7	5.3	1.4	3.8

Canopy closure and ground cover

	Zone 1		Zone 2		Zone 3	
	0-10 meters		10 - 20 meters		20 - 30 meters	
	(%)		(%)		(%)	
Canopy closure	25		13		39	
Shrub cover	39		30		23	
Grass/forb cover	58		68		67	

Predominant landform in each zone

	Zone 1		Zone 2		Zone 3	
	0-10 meters		10 - 20 meters		20 - 30 meters	
	(%)		(%)		(%)	
Hillslope	50		50		50	
High terrace	0		0		0	
Low terrace	0		0		0	
Floodplain	50		50		50	
Wetland/meadow	0		0		0	
Stream channel	0		0		0	
Roadbed/Railroad	0		0		0	
Riprap	0		0		0	
Surface slope (%)	14		12		14	

RIPARIAN ZONE VEGETATION

Reach 1

Reach 1

Unit	Side	Zone	Surface	Slope	Cover (percent)				Diameter class (cm)					Notes	
					Canopy	Shrub	Grass		3-15	15-30	30-50	50-90	>90		
1	LF	1	HS	25	90	90	10	Conifer							
								Hardwood	3						
1	LF	2	HS	30	50	80	10	Conifer							
								Hardwood		4					
1	LF	3	HS	30	100	80	10	Conifer			1	1	2		
								Hardwood							
1	RT	1	FP	0	0	30	70	Conifer	1						
								Hardwood							
1	RT	2	FP	0	0	0	100	Conifer							
								Hardwood							
1	RT	3	FP	0	0	0	100	Conifer							
								Hardwood							
17	LF	1	HS	41	0	25	60	Conifer	2						
								Hardwood							
17	LF	2	HS	24	0	10	90	Conifer	5						
								Hardwood							
17	LF	3	HS	21	45	0	90	Conifer	1						
								Hardwood	3	6					
17	RT	1	FP	0	0	0	100	Conifer							SHEEP
								Hardwood							GRAZING
17	RT	2	FP	0	0	0	100	Conifer							PASTURE
								Hardwood							
17	RT	3	FP	0	0	0	100	Conifer							
								Hardwood							
26	LF	1	HS	20	60	90	10	Conifer							
								Hardwood	6						
26	LF	2	HS	20	30	90	10	Conifer							
								Hardwood	3						
26	LF	3	HS	30	90	60	0	Conifer							
								Hardwood	5	2					
26	RT	1	FP	0	0	0	100	Conifer							
								Hardwood	2						
26	RT	2	FP	0	0	0	100	Conifer							
								Hardwood							
26	RT	3	FP	0	0	0	100	Conifer							
								Hardwood							

Comment Summary

Oregon Plan Monitoring Sites 2002

MONITORING AREA: **5-SC** SITE ID: **128** CEDAR CREEK PRE-TX (SC-128)

<u>UNIT#</u>	<u>TYPE</u>	<u>CHAN</u>	<u>DIST. (m)</u>	<u>COMMENTS</u>	<u>NOTE ESTIMATOR</u>	<u>NOTE NUMERATOR</u>
1	LP	00	10.4		START	
2	LP	00	45.9			ESTIMATED DUE TO THICK
3	RI	00	48.4		OLD START SIGN AT END	
6	LP	00	144.9		TW FROM WINTER SURV	LOT OF HARDWOODS
8	LP	00	187.9		T=16C	
9	RI	01	197.5	TJ/	TJ/	
10	RI	11	197.5		ACW = 1.5	TRIB UNIT T=14.5C
12	LP	00	249.6			LOT OF GRASS, OPAQUE W
13	LP	01	274	TJ/	TJ/	
14	RI	11	274		UNNAMED NOT ON MAP	TRIB UNIT
15	LP	01	300.8	TJ/	TJ/	
16	RI	11	300.8		ESTIMATED DUE TO ACC	TRIB UNIT
18	LP	00	332.5	SS		MAY BE TJ, CAN'T SEE IT
24	RI	01	394.8	TJ	TJ/	
25	RI	11	394.8		ACW=.6	TRIB UNIT
26	LP	00	414.8	RIP #3		
27	LP	01	441.1	TJ		
28	RI	11	441.1			TRIB UNIT
29	BW	10	441.1			OFF OF TRIBUNIT
31	LP	00	493.4		END SURVEY	END OF SURVEY

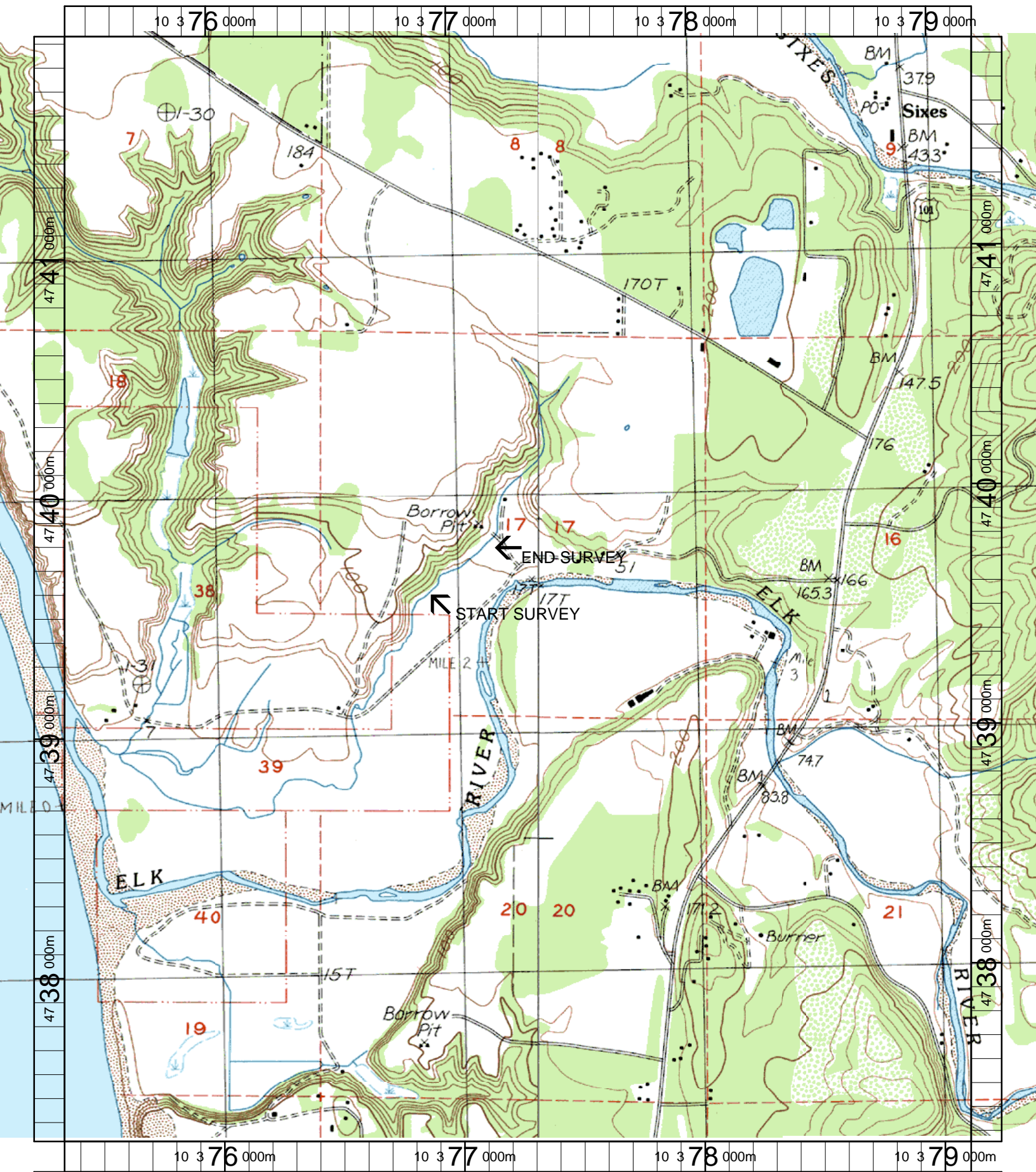

Name: CAPE BLANCO
 Date: 3/21/2003
 Scale: 1 inch equals 1666 feet

Location: 10 377256 E 4739596 N
 Caption: CEDAR CREEK RESTORATION SITE - ELK BASIN