

**ODFW AQUATIC INVENTORY PROJECT**  
**OREGON PLAN FOR SALMON & WATERSHEDS**  
**STREAM RESTORATION HABITAT REPORT**

STREAM: Rock Creek (MC-341)  
BASIN: Devils Lake  
SURVEY TYPE: Post-Tx  
DATE: September 20, 2007  
SURVEY CREW: Lanoah Babcock, Kara Morris, Sharon Tippery, Josh Togstad,  
Robert Gomez  
REPORT PREPARED BY: Paul Jacobsen  
BASIN AREA: 13.8 km<sup>2</sup>  
USGS MAPS: Devils Lake  
ECOREGION: Coast Range Coastal Uplands

**GENERAL DESCRIPTION:**

The Rock Creek habitat survey extended 5,127 meters. The channel was alternately constrained by hillslopes and terraces in a broad valley floor. The average valley width index was 4.6 (range: 1.0-12.0). Land use for the reach was second growth (15-30 cm dbh) and large (30-50 cm dbh) trees. The average unit gradient was 1.6 percent. Riffles (50%) and scour pools (36%) dominated stream habitat. Gravel (38%) and sand (38%) dominated stream substrate. Wood volume was moderate at 27.8 m<sup>3</sup>/100m.

**COMMENTS:**

There were no potential barriers to upstream fish migration in the surveyed length.

The crew noted several habitat structures during the survey.

REACH 1

T07S-R11W-S13NW

REACH 1

**Valley and Channel Summary**

Valley Characteristics (Percent Reach Length)

<u>Narrow Valley Floor</u>		<u>Broad Valley Floor</u>	
Steep V-shape	0%	Constraining Terraces	100%
Moderate V-shape	0%	Multiple Terraces	0%
Open V-shape	0%	Wide Floodplain	0%
Valley Width Index	4.6	VWI Range:	1 - 12

Channel Morphology (Percent Reach Length)

<u>Constrained</u>		<u>Unconstrained</u>	
Hillslope	0%	Single Channel	0%
Bedrock	0%	Multiple Channel	0%
Terrace	0%	Braided Channel	0%
Alt. Terrace/Hill	100%		
Landuse	0%		

Channel Characteristics

<u>Type</u>	<u>Length (m)</u>	<u>Area (m2)</u>	<u>Dry Units</u>
Primary Channel	5,127	24,083	0
Secondary Channel	47	61	0
Off-Channel Units	77	104	0

Channel Dimensions (m)

<u>Wetted</u>	<u>Active</u>	<u>Floodprone</u> n = 21	<u>First Terrace</u> n = 16
Width: 4.3	Width: 7.2	9.5 ( 5 - 12 )	11.0 ( 5.5 - 15.8 )
Depth: 0.34	Height: 0.5	0.9 ( 0.6 - 1.4 )	1.1 ( 0.7 - 1.65 )

W:D ratio: 16.5

Entrenchment (ACW:FPW ratio): 1.4

Stream Flow Type: LF

Habitat Units/100m (total channel length): 4.7

Average Unit Gradient: 1.6%

Habitat Units/100m (primary channel length): 4.8

Water temperature (°C): 12.0 - 12.0

**Riparian, Bank, and Wood Summary**

	<u>Primary</u>	<u>Secondary</u>
Land Use:	ST	LT
Riparian Vegetation:	D30	S

Bank Condition and Shade

<u>Bank Status</u>	<u>Percent Reach Length</u>	<u>Shade (% of 180)</u>
Actively Eroding:	18%	Reach avg: 78%
Undercut Banks:	4%	Range: 31 - 100

Large Wood Debris

	<u>Total</u>	<u>Total / 100m primary channel</u>
All pieces (>=3m x 0.15m):	952	18.6
Volume (m <sup>3</sup> ):	1,424	27.8
Key pieces (>=12m x 0.60m):	75	1.5

OREGON DEPT OF FISH AND WILDLIFE

ROCK CREEK POST-TX (2-MC, 341)

HABITAT INVENTORY

Report Date: 11/14/2007

Survey Date:

9/11/2007

REACH 1		T07S-R11W-S13NW					REACH 1					
HABITAT DETAIL												
Habitat Type	Number Units	Total Length (m)	Avg Width (m)	Avg Depth (m)	Total Area (m <sup>2</sup> )	Large Boulders (#>0.5m)	Substrate Percent Wetted Area					
							S/O	Snd	Grvl	Cbl	Bldr	Bdrk
CULVERT CROSSING	3	55	1.8	0.22	96	0	8	26	49	13	3	0
POOL-BEAVER DAM	7	305	7.0	0.94	2,604	0	29	49	19	3	0	1
POOL-LATERAL SCOUR	93	1,696	4.9	0.59	8,382	0	22	50	22	3	0	3
POOL-PLUNGE	1	7	4.5	0.90	32	0	28	33	6	6	0	28
POOL-STRAIGHT SCOUR	2	30	10.0	1.00	295	0	25	58	18	0	0	0
RAPID/BEDROCK	2	38	5.1	0.15	186	0	16	36	21	8	0	19
RAPID/BOULDERS	3	26	1.0	0.05	28	0	15	34	32	19	0	0
RIFFLE	89	2,663	3.7	0.14	10,371	9	13	28	52	5	0	2
RIFFLE W/ POCKETS	7	338	5.5	0.31	1,854	0	17	28	54	1	0	0
STEP/BEAVER DAM	5	5	5.5	0.08	29	0	35	52	13	0	0	0
STEP/BEDROCK	2	6	3.8	0.10	22	0	12	10	5	0	0	74
STEP/BOULDERS	2	1	1.9	0.04	3	0	25	33	43	0	0	0
STEP/COBBLE	17	69	4.0	0.08	306	0	10	20	61	9	0	0
STEP/LOG	12	10	3.4	0.03	40	0	17	38	44	1	0	0
<b>Total:</b>	<b>245</b>	<b>5,250</b>	<b>4.3</b>	<b>0.34</b>	<b>24,248</b>	<b>9</b>	<b>Avg: 17</b>	<b>38</b>	<b>38</b>	<b>4</b>	<b>0</b>	<b>3</b>

HABITAT SUMMARY									
Habitat Group	Number Units	Total Length (m)	Avg Width (m)	Avg Depth (m)	Wetted Area		Large Boulders		
					(m <sup>2</sup> )	Percent	Number	(# / 100m <sup>2</sup> )	
Dammed & BW Pools	7	305	7.0	0.94	2,604	10.74%	0	0.0	
Scour Pools	96	1,733	5.0	0.60	8,708	35.91%	0	0.0	
Glides	0	0			0	0.00%	0	0.0	
Riffles	96	3,002	3.8	0.16	12,225	50.42%	9	0.1	
Rapids	5	64	2.6	0.09	214	0.88%	0	0.0	
Cascades	0	0			0	0.00%	0	0.0	
Step/Falls	38	92	3.9	0.07	400	1.65%	0	0.0	
Dry	0	0			0	0.00%	0	0.0	
Culverts	3	55	1.8	0.22	96	0.40%	0	0.0	

POOL SUMMARY			
	Total	Total of all Channel Lengths # / Km	Primary Channel Length # / Km
All Pools:	103	19.6	20.1
Pools >=1m deep:	11	2.1	2.1
Complex pools (LWD pieces>=3):	53	10.1	10.3
Pool frequency (channel widths/pool):	7.1		
Residual pool depth (avg):	0.51		

OREGON DEPARTMENT OF FISH AND WILDLIFE  
HABITAT INVENTORY

ROCK CREEK POST-TX  
GCG: 2-MC SITE ID: 341

Survey Date 9/11/2007  
Report Date: 11/7/2007

RIPARIAN ZONE  
VEGETATION SUMMARY

REACH 1

Summary of Riparian Zone (0-30m) 20 transects

Total hardwoods/1000	570
Total conifers/1000 ft	515
Total conifers >20" dbh/1000 ft	43
Total conifers >35" dbh/1000 ft	15

Average number of trees in a 5-meter wide band

Diameter class (cm)	Zone 1 0-10 meters		Zone 2 10 - 20 meters		Zone 3 20 - 30 meters		Zones 1-3 0-30 meters	
	Conifer	Hardwood	Conifer	Hardwood	Conifer	Hardwood	Conifer	Hardwood
3-15cm	0.4	1.1	1.0	1.2	1.9	0.8	3.3	3.1
15-30cm	0.6	1.4	0.7	1.2	1.2	1.3	2.4	3.9
30-50cm	0.3	0.9	1.0	0.5	0.8	0.6	2.0	1.9
50-90cm	0.2	0.3	0.2	0.1	0.1	0.2	0.5	0.5
>90cm	0.2	0.0	0.0	0.0	0.1	0.0	0.3	0.0
Total/100m2	1.5	3.6	2.9	3.0	4.1	2.8	2.8	3.1

Canopy closure and ground cover

	Zone 1 0-10 meters		Zone 2 10 - 20 meters		Zone 3 20 - 30 meters	
	(%)		(%)		(%)	
Canopy closure	50		59		60	
Shrub cover	34		30		27	
Grass/forb cover	51		49		45	

Predominant landform in each zone

	Zone 1 0-10 meters		Zone 2 10 - 20 meters		Zone 3 20 - 30 meters	
	(%)		(%)		(%)	
Hillslope	43		71		74	
High terrace	51		31		23	
Low terrace	3		0		0	
Floodplain	0		0		0	
Wetland/meadow	0		0		0	
Stream channel	3		0		0	
Roadbed/Railroad	0		0		3	
Riprap	0		0		0	
Surface slope (%)	24		31		33	

Summary of Riparian Zone (0-30m) for all reaches

20 transects

Summary of riparian zone (0-100 feet) extrapolated to 1,000 feet along stream

Total hardwoods/1000	570
Total conifers/1000 ft	515
Total conifers >20" dbh/1000 ft	43
Total conifers >35" dbh/1000 ft	15

**Average number of trees in a 5-m wide band**

Diameter class (cm)	Zones 1-3	
	<u>0-30 meters</u>	
	<u>Conifer</u>	<u>Hardwood</u>
3-15cm	3.3	3.1
15-30cm	2.4	3.9
30-50cm	2.0	1.9
50-90cm	0.5	0.5
>90cm	0.3	0.0

**RIPARIAN ZONE VEGETATION**

Reach 1

Reach 1

Unit	Side	Zone	Surface	Slope	Cover (percent)				Diameter class (cm)					Notes	
					Canopy	Shrub	Grass		3-15	15-30	30-50	50-90	>90		
6	LT	1	HT	0	65	5	85	Conifer							6 M = HT OTHER 4 M = HS
								Hardwood	1	1	1				
6	LT	2	HS	65	55	45	25	Conifer							
								Hardwood		2	2	1			
6	LT	3	HS	60	70	45	20	Conifer							
								Hardwood			4				
6	RT	1	HT	0	60	5	90	Conifer							
								Hardwood		1	1				
6	RT	2	HT	0	65	0	85	Conifer							
								Hardwood		1					
6	RT	3	HT	0	65	5	90	Conifer							
								Hardwood	1						
15	LT	1	HT	0	50	0	90	Conifer							
								Hardwood		2	2	2			
15	LT	2	HT	0	60	5	85	Conifer							
								Hardwood	3	2					
15	LT	3	HT	0	55	10	85	Conifer							SAW A FROG
								Hardwood	2	1		1			
15	RT	1	HT	0	45	15	80	Conifer							
								Hardwood		2					
15	RT	2	HS	55	85	5	5	Conifer		1	1				
								Hardwood		2	1				
15	RT	3	HS	60	80	0	0	Conifer		3	1	1	2		
								Hardwood							
25	LT	1	SC	90	40	30	70	Conifer							
								Hardwood		1	1				
25	LT	2	HS	80	50	35	60	Conifer							
								Hardwood		3	2	1			
25	LT	3	HS	75	60	40	35	Conifer							
								Hardwood		3	2				
25	RT	1	HT	0	55	10	90	Conifer							
								Hardwood		1	1				
25	RT	2	HT	0	55	15	80	Conifer							
								Hardwood	2		1				
25	RT	3	HT	0	55	25	60	Conifer							
								Hardwood		3	1	2			

31	LT	1	HT	0	55	25	50	Conifer		2		1
								Hardwood				
31	LT	2	HT	0	70	15	55	Conifer				
								Hardwood	3			
31	LT	3	HS	30	55	5	45	Conifer			2	1
								Hardwood				
31	RT	1	HS	30	70	35	40	Conifer		2	1	
								Hardwood				
31	RT	2	HS	20	60	60	25	Conifer				
								Hardwood				
31	RT	3	HS	25	60	45	20	Conifer				
								Hardwood	4		1	
41	LT	1	HT	0	50	25	70	Conifer				
								Hardwood				
41	LT	2	HT	0	60	15	60	Conifer			2	1
								Hardwood				
41	LT	3	HT	0	65	35	50	Conifer	3	1		
								Hardwood		1	2	
41	RT	1	HS	0	60	0	5	Conifer			1	
								Hardwood			1	
41	RT	2	HS	45	75	0	15	Conifer		1	2	
								Hardwood				
41	RT	3	HS	35	65	10	5	Conifer				
								Hardwood				
51	LT	1	HT	0	70	15	70	Conifer				
								Hardwood	2		1	
51	LT	2	HS	45	75	10	70	Conifer			3	
								Hardwood			1	
51	LT	3	RB	0	0	0	35	Conifer				
								Hardwood	1			
51	RT	1	HS	65	65	5	35	Conifer				
								Hardwood	2			
51	RT	2	HS	45	60	10	35	Conifer		1	2	
								Hardwood		1		
51	RT	3	HS	20	65	10	55	Conifer		1	3	
								Hardwood				
57	LT	1	HT	0	45	15	75	Conifer				
								Hardwood		2	1	
57	LT	2	HT	0	50	5	85	Conifer				
								Hardwood				
57	LT	3	HT	0	75	30	70	Conifer				
								Hardwood	1	2		
57	RT	1	HS	80	65	15	50	Conifer	2	1		
								Hardwood				1
57	RT	2	HS	40	60	35	30	Conifer		1	1	
								Hardwood	1	1		

57	RT	3	HS	35	65	35	20	Conifer	1	2		
								Hardwood	1	1		
68	LT	1	HS	90	10	15	5	Conifer				
								Hardwood		1		
68	LT	2	HS	40	75	5	5	Conifer				ESTIMATED
								Hardwood	3	1		
68	LT	3	HS	20	75	5	0	Conifer	4	1		TREES PLANTED
								Hardwood				
68	RT	1	HT	0	65	15	60	Conifer		1		
								Hardwood			2	1
68	RT	2	HT	0	85	15	40	Conifer	1			
								Hardwood	2			
68	RT	3	HT	0	85	5	65	Conifer			1	
								Hardwood	1	1		
76	LT	1	HS	70	60	30	45	Conifer				
								Hardwood	2	2		
76	LT	2	HS	35	65	40	35	Conifer				
								Hardwood	3	1		
76	RT	1	HT	0	85	40	60	Conifer				
								Hardwood				
76	RT	2	HS	35	60	50	50	Conifer				
								Hardwood				
76	RT	3	HS	40	90	0	40	Conifer		3		PLANTING.
								Hardwood				
86	LT	1	HS	35	50	45	35	Conifer				
								Hardwood	2			
86	LT	2	HS	20	65	25	55	Conifer			1	
								Hardwood			1	
86	LT	3	HS	20	45	50	45	Conifer			1	
								Hardwood		3		
86	RT	1	HS	20	0	30	0	Conifer				
								Hardwood	5			
86	RT	2	HS	20	0	0	0	Conifer	4	1		
								Hardwood				
86	RT	3	HS	25	0	0	0	Conifer	4	1		
								Hardwood				
92	LT	1	HT	0	50	70	30	Conifer		1		
								Hardwood				
92	LT	2	HS	40	60	50	50	Conifer				
								Hardwood	3			
92	LT	3	HS	60	55	40	20	Conifer				
								Hardwood	3			
92	RT	1	HT	0	25	80	20	Conifer			1	1
								Hardwood				
92	RT	2	HS	35	100	10	0	Conifer	6			
								Hardwood				



92	RT	3	HS	25	100	0	0	Conifer	7			
								Hardwood				
107	LT	1	LT	0	0	45	45	Conifer				
								Hardwood				
107	LT	2	HS	85	30	55	40	Conifer			1	
								Hardwood				
107	LT	3	HS	100	80	15	20	Conifer	1			ESTIMATED
								Hardwood	2			
107	RT	1	HS	55	0	65	25	Conifer				
								Hardwood				
107	RT	2	HS	75	0	70	20	Conifer				
								Hardwood				
107	RT	3	HS	90	15	75	20	Conifer		1		
								Hardwood				
119	LT	2	HT	0	45	55	30	Conifer		2	1	
								Hardwood				
119	LT	3	HT	0	0	20	25	Conifer	8			CONIFERS 5 FEET TALL
								Hardwood				
119	RT	1	HS	90	55	20	55	Conifer		1	1	
								Hardwood	2			
119	RT	2	HS	5	20	20	75	Conifer		2		
								Hardwood	3			
119	RT	3	HS	7	20	70	25	Conifer	2	2		
								Hardwood				
141	LT	1	HS	60	70	90	10	Conifer	1	2		
								Hardwood				
141	LT	2	HS	65	55	90	10	Conifer		1		
								Hardwood				
141	LT	3	HS	65	45	75	25	Conifer				
								Hardwood				
141	RT	1	HS	45	60	100	0	Conifer	2			
								Hardwood		1		
141	RT	2	HS	40	50	100	0	Conifer	2			
								Hardwood				
141	RT	3	HS	35	30	100	0	Conifer	1			CLEARCUT ZONE
								Hardwood				
150	LT	1	HT	0	60	80	20	Conifer				
								Hardwood	1	2	1	
150	LT	2	HS	30	80	50	40	Conifer				
								Hardwood	1			
150	LT	3	HS	30	65	45	40	Conifer				
								Hardwood	2			
150	RT	1	HT	0	50	75	25	Conifer				
								Hardwood		1		
150	RT	2	HT	0	55	55	40	Conifer			1	
								Hardwood	1			

150	RT	3	HS	45	50	20	75	Conifer				
								Hardwood				
163	LT	1	HT	0	25	30	70	Conifer				
								Hardwood			2	
163	LT	2	HT	0	40	75	25	Conifer	1			
								Hardwood				
163	LT	3	HT	0	70	75	25	Conifer				
								Hardwood			1	
163	RT	1	HT	0	5	40	60	Conifer				
								Hardwood				
163	RT	2	HT	0	5	70	30	Conifer				
								Hardwood				
163	RT	3	HT	0	5	65	35	Conifer				
								Hardwood		1		
185	LT	1	HS	20	50	25	75	Conifer				1
								Hardwood	3			
185	LT	2	HS	30	75	25	75	Conifer			1	
								Hardwood				
185	LT	3	HS	35	70	35	65	Conifer				
								Hardwood	1			
185	RT	1	HT	0	55	45	55	Conifer				1
								Hardwood	1	1		
185	RT	2	HT	0	80	35	60	Conifer	1		1	
								Hardwood				
185	RT	3	HS	20	85	30	65	Conifer	1		1	
								Hardwood				
205	LT	1	HS	50	85	10	90	Conifer	2	1		
								Hardwood				
205	LT	2	HS	40	85	5	95	Conifer	3	1		
								Hardwood				
205	LT	3	HS	65	90	0	100	Conifer	3			
								Hardwood				
205	RT	1	HS	45	85	5	95	Conifer	2			
								Hardwood		2		
205	RT	2	HS	45	85	0	100	Conifer	2	2		
								Hardwood				
205	RT	3	HS	55	90	0	100	Conifer	3	1		
								Hardwood				
225	LT	1	HT	10	70	50	50	Conifer				
								Hardwood		5		
225	LT	2	HS	60	75	10	90	Conifer		2		
								Hardwood				
225	LT	3	HS	60	85	5	95	Conifer	1	3		
								Hardwood				
225	RT	1	HS	50	60	75	25	Conifer	1			
								Hardwood				

225	RT	2	HS	40	70	20	80	Conifer			
								Hardwood	4		
225	RT	3	HS	50	80	5	95	Conifer	2		
								Hardwood	4		
241	LT	1	HS	30	40	30	70	Conifer			
								Hardwood			
241	LT	2	HS	45	60	10	90	Conifer			
								Hardwood	3	2	
241	LT	3	HS	50	80	10	90	Conifer	3		
								Hardwood			
241	RT	1	HT	0	45	20	80	Conifer			
								Hardwood	4	2	
241	RT	2	HS	40	75	10	90	Conifer	3	1	
								Hardwood	1		
241	RT	3	HS	45	80	10	90	Conifer	3	1	
								Hardwood	1	1	

COMMENT SUMMARY

MONITORING AREA: 2-MC      SITE ID: 341      STREAM: ROCK CREEK POST-TX

UNIT#	TYPE	CHAN	DIST. (m)	COMMENTS	NOTES
1	LP	00	95	DJ, BV	CHEW, SLIDES, TUNNELS
2	LP	00	132.8	BV	SLIDES
3	RI	00	182.8	DJ	JUV FISH
5	LP	00	224.5		JUV FISH
7	LP	00	267.8		JUV FISH
9	LP	00	321.2		JUV FISH
11	LP	00	354	DJ	
14	LP	00	480.6		BRRRRR!
17	LP	00	566.9		JUV FISH
18	LP	00	587.9	HS, DJ	JUV FISH
19	LP	00	607.9		ITS SO COLD!
21	LP	00	682.3		JUV FISH
24	RI	02	725.6	WL	SMALL HERON
25	LP	00	739.1		JUV FISH
28	RP	00	836.4		MAX POCKET DEPTH .8 ASSOCIATED W/ WOOD
29	RI	00	886.4	WL	SMALL HERON?
30	RP	00	936.4		JUV FISH
32	RP	01	1036.4	/TJ, HS	MAX POCKET DEPTH=1.0
37	SP	00	1099.7	CE	
38	CC	00	1128	CC	4.3M X 3.1M CORRUGATED METAL BOTTOM
40	LP	00	1197.5	HS	
41	RI	00	1247.5	HS	JUV FISH

COMMENT SUMMARY

MONITORING AREA: 2-MC      SITE ID: 341      STREAM: ROCK CREEK POST-TX

UNIT#	TYPE	CHAN	DIST. (m)	COMMENTS	NOTES
42	RI	00	1297.5		JUV FISH
43	RI	00	1347.5	HS	
47	SL	01	1403.2	/TJ, HS	
49	LP	00	1431.2		JUV FISH
50	RP	00	1486.2		JUV FISH
51	LP	00	1512	HS	START DAY 2 T=12.5C
52	RI	00	1572		JUV FISH
54	LP	00	1604.1		JUV FISH
55	LP	00	1631.1		JUV FISH
56	RI	00	1681.1	HS	
57	RI	00	1734.1	HS	JUV FISH
58	RI	00	1774.1	HS	
59	SP	00	1785.6	CE, HS, WL	CRAWDAD
60	CC	00	1799.2	CC	2.5M X 2.3 CORRUGATED METAL BOTTOM
61	RI	01	1838.9	/TJ	T=12C
63	LP	00	1860.3	WL	SMALL HERON-LIKE BIRD
64	SL	00	1860.9	HS	
65	RI	00	1910.9	WL	TRACKS
66	RI	00	1960.9	HS	JUV FISH
68	LP	00	1994.5	HS, WL	TRACKS
69	RP	00	2037.8	HS	JUV FISH
70	LP	00	2054.2	HS	

COMMENT SUMMARY

MONITORING AREA: 2-MC      SITE ID: 341      STREAM: ROCK CREEK POST-TX

UNIT#	TYPE	CHAN	DIST. (m)	COMMENTS	NOTES
71	RI	00	2111.2	DJ, WL, HS	TRACKS
72	LP	00	2126.9	HS	JUV FISH
73	SL	00	2127.6	DJ	
74	LP	00	2162.3	WL	TRACKS-ELK
75	RI	00	2212.3	WL	ELK TRACKS
76	RI	00	2251.5	WL	ELK TRACKS
77	LP	00	2269.2		JUV FISH
78	RI	00	2319.2		JUV FISH
79	LP	00	2346.2	WL	SMALL MAMMAL TRACKS
80	RI	00	2389.7	DJ, HS	JUV FISH
81	LP	00	2415.4		JUV FISH
82	RI	01	2471.4	/TJ	
84	LP	00	2503.7	DJ	JUV FISH
87	LP	00	2596.2		JUV FISH 1=8 INCHES
88	LP	00	2614.8		JUV FISH
89	RI	00	2664.8		JUV FISH
90	RI	00	2714.8		JUV FISH
91	RI	00	2744.8	DJ	JUV FISH
92	SL	10	2744.8	DJ	
100	BP	00	2769.8	BV, HS	BEGAN AT
101	SB	00	2770.8	BV	WATER SEEPING THROUGH
102	BP	00	2820.8	DJ, HS, BV	TRAILS

COMMENT SUMMARY

MONITORING AREA: 2-MC      SITE ID: 341      STREAM: ROCK CREEK POST-TX

UNIT#	TYPE	CHAN	DIST. (m)	COMMENTS	NOTES
103	RI	00	2872.8	DJ, HS	
104	LP	00	2905.5	HS	JUV FISH
105	RI	00	2943.9	WL, HS	PRINTS-SMALL MAMMAL
106	LP	00	2958.5	HS, DJ	JUV FISH
107	RI	00	3013.5	AM, DJ, HS	FROG
108	RI	00	3064.5	HS	
109	RI	01	3088.5	HS	
112	RP	00	3129.8	HS, DJ	JUV FISH
113	RI	00	3171.8	/EI, WL	BIRD
116	SB	00	3182.7	BV	BLOWING OUT
117	LP	00	3196.4		JUV FISH
118	LP	00	3226.7	DJ	JUV FISH
119	RP	00	3276.7		JUV FISH
120	LP	00	3310.7	DJ	JUV FISH
122	RI	00	3352.1		END-START AT BEGINNING OF 02-FLAGGED IN MIDDLE OF STREAM
126	LP	00	3382.8	BV, WL	DEER TRAIL
128	LP	00	3406.6	DJ	
140	PP	00	3565.5	DJ	
145	RI	00	3653.5	HS, WL	GREAT BLUE HERON
146	SD	00	3654.3	BD	
147	BP	00	3694.3	DJ, BV	COHO THROUGHOUT
157	LP	00	3769.7	BV	

COMMENT SUMMARY

MONITORING AREA: 2-MC      SITE ID: 341      STREAM: ROCK CREEK POST-TX

UNIT#	TYPE	CHAN	DIST. (m)	COMMENTS	NOTES
159	SD	00	3780.2	BD	
160	BP	00	3808.2	BV	HARDPAN
163	RI	01	3832.2	TJ/	
164	RI	11	3832.2	BV	SGS, ACW=3.2, T=13, UTM 0423848, 4981771, 3D
165	SD	00	3834.2	BD, DJ	
166	BP	00	3844.3	BV	
167	CC	00	3857.3	CC	CORREGATED METAL, DIA:2.5
168	SD	00	3857.8	BD	
169	BP	00	3980.8	HS, BV, AM	FROG
170	RI	00	4006.4	HS	
173	LP	00	4036.3	HS	
175	LP	00	4072.9	HS	
176	RI	00	4081.7		CHOKE CABLE ACROSS CREEK 0.6M HIGH
177	LP	00	4096.1	WL	DEER TRACKS
178	RI	00	4134.2	HS	
181	LP	00	4171.1	HS	
183	LP	00	4195.7	HS	
186	RI	11	4207		ACW=1.2, T=12
189	LP	00	4243.9	HS	
191	LP	00	4263.9	HS	
205	RI	01	4458.5	HS, /TJ	
206	RB	11	4458.5		ACW=1.8, T=12



COMMENT SUMMARY

MONITORING AREA: 2-MC      SITE ID: 341      STREAM: ROCK CREEK POST-TX

UNIT#	TYPE	CHAN	DIST. (m)	COMMENTS	NOTES
207	SD	00	4459.5	BD	
208	BP	00	4488.5	BV	
218	LP	00	4594.5	HS	
223	RI	00	4697.5	HS	
230	RI	00	4796.1	HS	
233	LP	01	4831.5	/TJ	
234	RB	11	4831.5		ACW=1.8,T=11
248	LP	00	5032.1	BV	
252	LP	00	5080.9		METAL PIPE

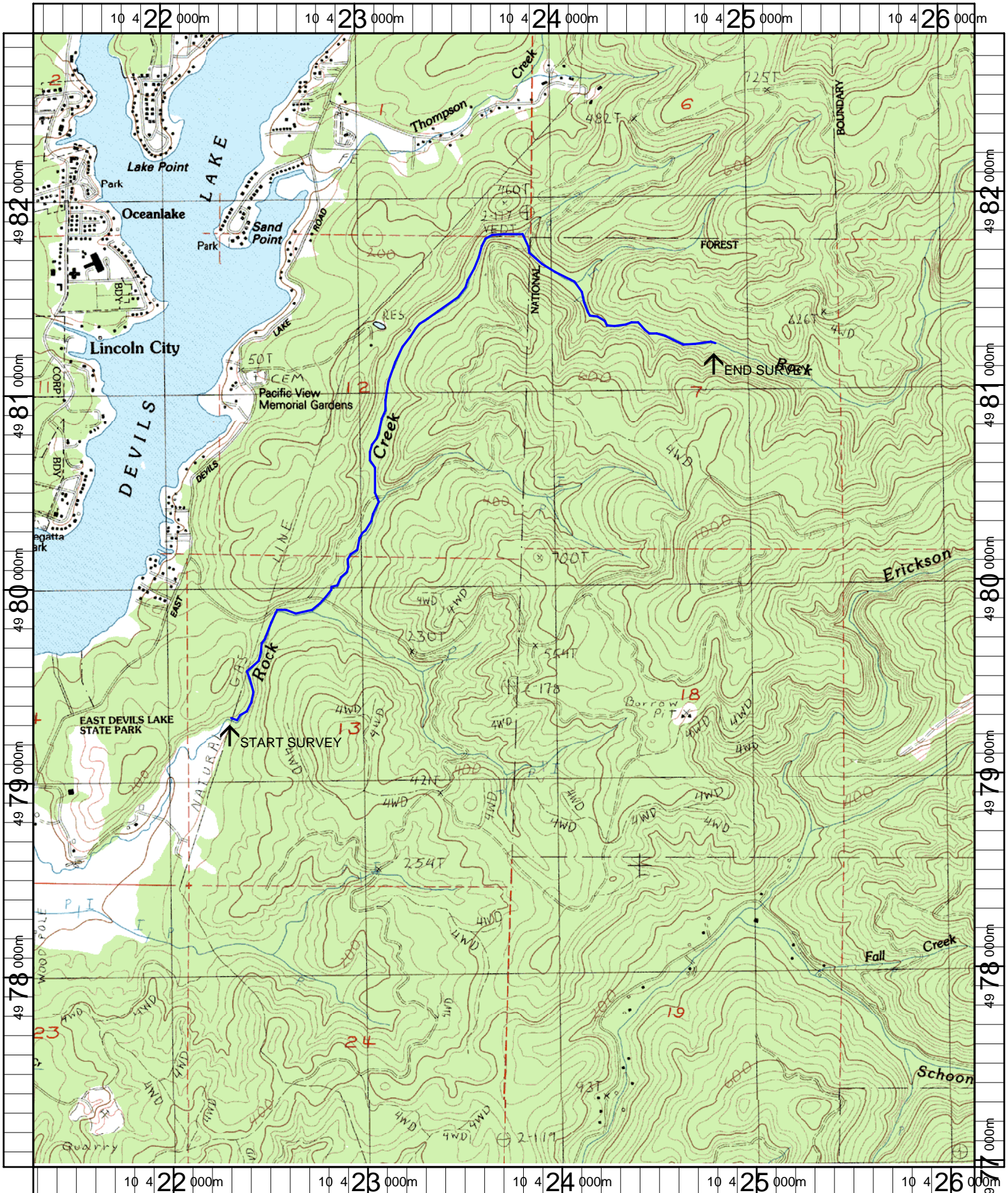

Name: DEVILS LAKE  
 Date: 5/9/2007  
 Scale: 1 inch equals 2000 feet

Location: 10 423734 E 4979918 N  
 Caption: ROCK CREEK RESTORATION SITE - DEVILS LAKE BASIN