

ODFW AQUATIC INVENTORY PROJECT
OREGON PLAN FOR SALMON & WATERSHEDS
STREAM RESTORATION HABITAT REPORT

STREAM: Munson Creek Tributary B (NC-344)
BASIN: Tillamook River
SURVEY TYPE: Post-Tx
DATE: February 20, 2008
SURVEY CREW: Sharon Tippery Matt Weeber
REPORT PREPARED BY: Sharon Tippery
BASIN AREA: 0.6 km²
USGS MAPS: Beaver
ECOREGION: Coast Range Coastal Uplands

GENERAL DESCRIPTION:

The Munson Creek Tributary B habitat survey extended 501 meters. The channel was alternately constrained by terrace and hillslope in a broad valley floor. The average valley width index was 2.6 (range: 1-4). Land use for the reach was large growth timber (30-50cm dbh) and young trees (3-15cm dbh). The average unit gradient was 11.1 percent. Cascades (86%) dominated stream habitat. Cobble (47%) and gravel (21%) dominated stream substrate. Wood volume was 41.3m³/100m.

COMMENTS:

There were no potential barriers to upstream fish migration in the surveyed length.

The crew noted several habitat structures and one large debris jam during the survey.

**OREGON DEPARTMENT OF FISH AND WILDLIFE
HABITAT INVENTORY**

**MUNSON CREEK TRIBUTARY B
GCG: 1-NC SITE ID: 344**

Survey Date: 2/20/2008

Report Date: 5/6/2008

T02S-R09W-S27SW

REACH 1

Valley and Channel Summary

Valley Characteristics (Percent Reach Length)

<u>Narrow Valley Floor</u>		<u>Broad Valley Floor</u>	
Steep V-shape	0%	Constraining Terraces	100%
Moderate V-shape	0%	Multiple Terraces	0%
Open V-shape	0%	Wide Floodplain	0%
Valley Width Index	2.6	VWI Range:	1 - 4

Channel Morphology (Percent Reach Length)

<u>Constrained</u>		<u>Unconstrained</u>	
Hillslope	0%	Single Channel	0%
Bedrock	0%	Multiple Channel	0%
Terrace	0%	Braided Channel	0%
Alt. Terrace/Hill	100%		
Landuse	0%		

Channel Characteristics

<u>Type</u>	<u>Length (m)</u>	<u>Area (m2)</u>	<u>Dry Units</u>
Primary	501	891	0
Secondary	0	0	0

Channel Dimensions (m)

<u>Wetted</u>	<u>Active</u>	<u>Floodprone</u> n = 4	<u>First Terrace</u> n = 2
Width: 2.3	Width: 3.5	5.0 (3.5 - 9.5)	5.8 (4.5 - 7)
Depth: 0.11	Height: 0.3	0.6 (0.5 - 0.7)	0.9 (0.8 - 1)

W:D ratio: 11.8

Stream Flow Type: MF

Average Unit Gradient: 11.1%

Water temperature (°C): 7.0 - 7.0

Entrenchment (ACW:FPW ratio): 1.4

Habitat Units/100m (total channel length): 5.0

Habitat Units/100m (primary channel length): 5.0

Riparian, Bank, and Wood Summary

	<u>Primary</u>	<u>Secondary</u>
Land Use:	LT	YT
Riparian Vegetation:	D15	S

Bank Condition and Shade

<u>Bank Status</u>	<u>Percent Reach Length</u>	<u>Shade (% of 180)</u>
Actively Eroding:		Reach avg:
Undercut Banks:		Range: -

Large Wood Debris

	<u>Total</u>	<u>Total / 100m primary channel</u>
All pieces (>=3m x 0.15m):	115	22.9
Volume (m ³):	207	41.3
Key pieces (>=12m x 0.60m):	9	1.8

OREGON DEPARTMENT OF FISH AND WILDLIFE

MUNSON CREEK TRIBUTARY B

HABITAT INVENTORY

GCG: 1-NC SITE ID: 344

Survey Date: 2/20/2008

Report Date: 5/6/2008 T02S-R09W-S27SW REACH 1

HABITAT DETAIL

Habitat Type	Number Units	Total Length (m)	Avg Width (m)	Avg Depth (m)	Total Area (m ²)	Large Boulders (#>0.5m)	Substrate Percent Wetted Area					
							S/O	Snd	Grvl	Cbl	Bldr	Bdrk
CASCADE/BEDROCK	1	10	0.5	0.00	5	0	15	5	5	5	0	70
CASCADE/BOULDERS	14	435	1.8	0.13	767	0	2	5	17	55	19	0
RAPID/BOULDERS	2	27	1.9	0.15	50	0	0	5	12	63	20	0
RIFFLE	1	21	1.8	0.15	38	0	0	10	67	19	5	0
STEP/LOG	7	9	3.5	0.08	31	0	11	24	25	37	2	0
Total:	25	501	2.3	0.11	891	0	Avg: 5	11	21	47	13	3

HABITAT SUMMARY

Habitat Group	Number Units	Total Length (m)	Avg Width (m)	Avg Depth (m)	Wetted Area		Large Boulders	
					(m ²)	Percent	Number	(# / 100m ²)
Dammed & BW Pools	0	0			0	0.00%	0	0.0
Scour Pools	0	0			0	0.00%	0	0.0
Glides	0	0			0	0.00%	0	0.0
Riffles	1	21	1.8	0.15	38	4.24%	0	0.0
Rapids	2	27	1.9	0.15	50	5.62%	0	0.0
Cascades	15	445	1.7	0.12	772	86.62%	0	0.0
Step/Falls	7	9	3.5	0.08	31	3.51%	0	0.0
Dry	0	0			0	0.00%	0	0.0
Culverts	0	0			0	0.00%	0	0.0

POOL SUMMARY

	Total of all Channel Lengths		Primary Channel Length
	<u>Total</u>	<u># / Km</u>	<u># / Km</u>
All Pools:	0	0.0	0.0
Pools >=1m deep:	0	0.0	0.0
Complex pools (LWD pieces>=3):	0	0.0	0.0
Pool frequency (channel widths/pool):	0.0		
Residual pool depth (avg):			

COMMENT SUMMARY

MONITORING AREA: 1-NC SITE ID: 344 STREAM: MUNSON CREEK TRIBUTARY B

UNIT#	TYPE	CHAN	DIST. (m)	COMMENTS	NOTES
1	CB	00	50	BC	
3	RB	00	114.5	/SS, HS	
8	CB	00	232.8		LARGE DEBRIS JAM AT LOWER END
13	CB	01	302.1	TJ/	
14	CR	00	312.1		HARDPAN
18	CB	00	375.1	HS	
21	CB	00	421.3		CRAYFISH CLAW

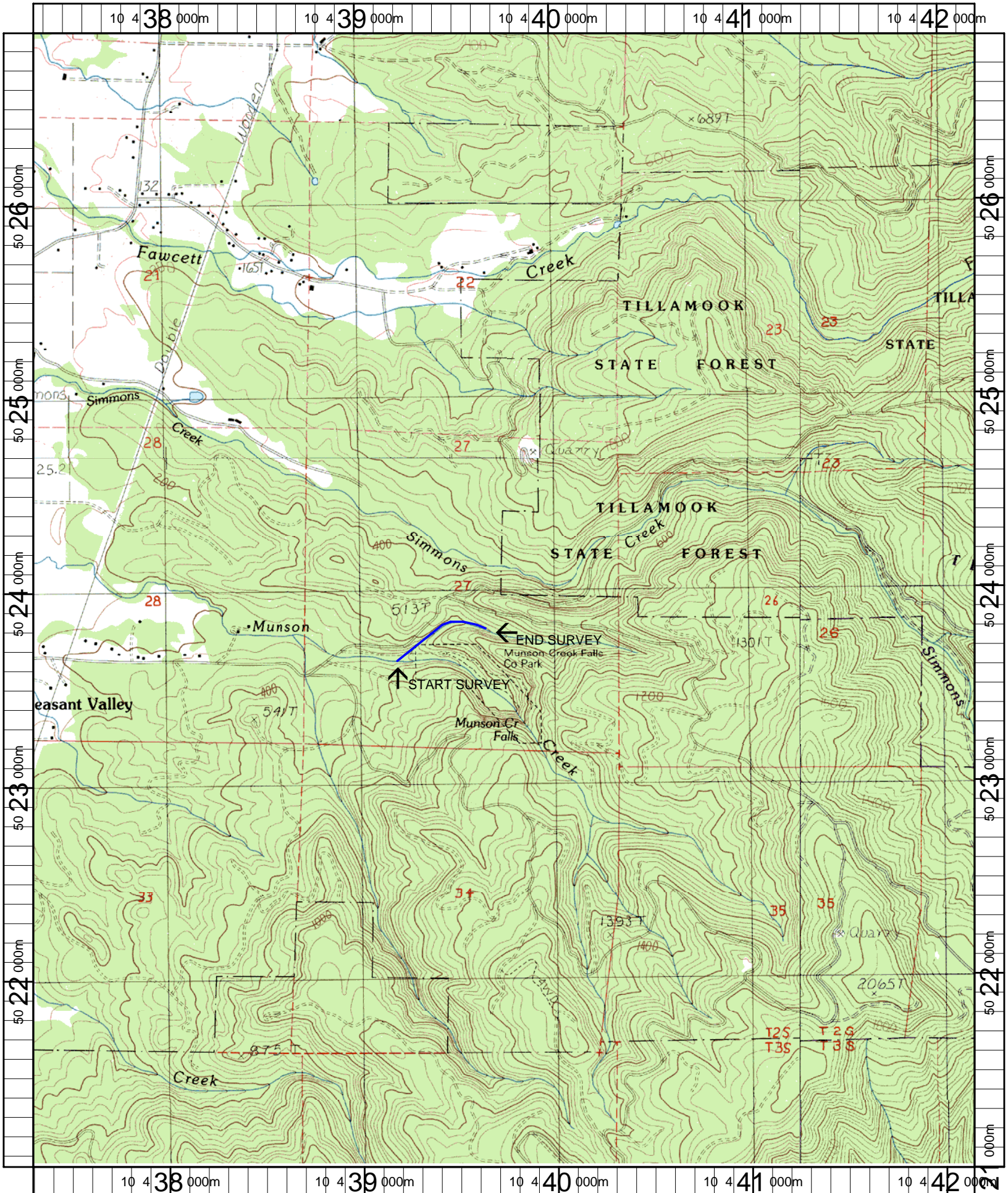

Name: BEAVER
 Date: 1/9/2007
 Scale: 1 inch equals 2000 feet

Location: 10 439744 E 5023946 N
 Caption: MUNSON CREEK TRIBUTARY B RESTORATION SITE -
 TILLAMOOK BASIN