

ODFW AQUATIC INVENTORY PROJECT
OREGON PLAN FOR SALMON & WATERSHEDS
STREAM RESTORATION HABITAT REPORT

STREAM: Munson Creek Tributary B (NC-344)
BASIN: Tillamook River
SURVEY TYPE: Pre-Tx
DATE: January 18, 2007
SURVEY CREW: Jason Hatfield, Scott Sebring
REPORT PREPARED BY: Paul Jacobsen
BASIN AREA: 0.6 km²
USGS MAPS: Beaver
ECOREGION: Coast Range Coastal Uplands

GENERAL DESCRIPTION:

The Munson Creek Tributary B habitat survey extended 494 meters. The channel was alternately constrained by hillslope and terrace in a broad valley floor. The average valley width index was 3.9 (range: 1.5-5). Land use for the reach was large timber (30-50 cm dbh) and second growth timber (15-30 cm dbh). The average unit gradient was 11.6 percent. Cascades (59%) and rapids (34%) dominated stream habitat. Gravel (50%) and cobble (31%) dominated stream substrate. Wood volume was very high at 42.4 m³/100m.

COMMENTS:

There were no potential barriers to upstream fish migration in the surveyed length.

A culvert was recorded 33 meters into the survey reach.

REACH 1 T02S-R09W-S27SW REACH 1

Valley and Channel Summary

Valley Characteristics (Percent Reach Length)

<u>Narrow Valley Floor</u>		<u>Broad Valley Floor</u>	
Steep V-shape	0%	Constraining Terraces	100%
Moderate V-shape	0%	Multiple Terraces	0%
Open V-shape	0%	Wide Floodplain	0%
Valley Width Index	3.9	VWI Range:	1.5 - 5

Channel Morphology (Percent Reach Length)

<u>Constrained</u>		<u>Unconstrained</u>	
Hillslope	0%	Single Channel	0%
Bedrock	0%	Multiple Channel	0%
Terrace	0%	Braided Channel	0%
Alt. Terrace/Hill	100%		
Landuse	0%		

Channel Characteristics

<u>Type</u>	<u>Length (m)</u>	<u>Area (m2)</u>	<u>Dry Units</u>
Primary Channel	494	996	0
Secondary Channel	0	0	0
Off-Channel Units	2	2	0

Channel Dimensions (m)

<u>Wetted</u>	<u>Active</u>	<u>Floodprone</u> n = 5	<u>First Terrace</u> n = 4
Width: 2.4	Width: 3.7	7.7 (2.5 - 15.3)	10.2 (6 - 14)
Depth: 0.20	Height: 0.4	0.8 (0.6 - 1)	1.8 (1.2 - 3)

W:D ratio: 9.9 Entrenchment (ACW:FPW ratio): 2.2
Stream Flow Type: MF Habitat Units/100m (total channel length): 5.2
Average Unit Gradient: 11.6% Habitat Units/100m (primary channel length): 5.3
Water temperature (°C): 6.5 - 6.5

Riparian, Bank, and Wood Summary

	<u>Primary</u>	<u>Secondary</u>
Land Use:	LT	ST
Riparian Vegetation:	S	D30

Bank Condition and Shade

<u>Bank Status</u>	<u>Percent Reach Length</u>	<u>Shade (% of 180)</u>
Actively Eroding:		Reach avg:
Undercut Banks:		Range: -

Large Wood Debris

	<u>Total</u>	<u>Total / 100m primary channel</u>
All pieces (>=3m x 0.15m):	85	17.2
Volume (m ³):	210	42.4
Key pieces (>=12m x 0.60m):	11	2.2

OREGON DEPT OF FISH AND WILDLIFE MUNSON CREEK TRIBUTARY B PRE-TX (1-NC, 344)

HABITAT INVENTORY

Report Date: 4/25/2007

Survey Date:

1/18/2007

REACH 1		T02S-R09W-S27SW					REACH 1					
HABITAT DETAIL												
Habitat Type	Number Units	Total Length (m)	Avg Width (m)	Avg Depth (m)	Total Area (m ²)	Large Boulders (#>0.5m)	Substrate Percent Wetted Area					
							S/O	Snd	Grvl	Cbl	Bldr	Bdrk
CASCADE/BOULDERS	7	293	2.2	0.14	585	0	0	10	54	31	4	0
CULVERT CROSSING	1	9	1.5	0.10	14	0	5	20	50	25	0	0
POOL-BACKWATER	1	2	1.0	0.45	2	0	0	50	30	20	0	0
POOL-LATERAL SCOUR	1	3	4.0	0.40	13	0	5	95	0	0	0	0
POOL-PLUNGE	4	8	2.5	0.44	19	0	0	10	64	23	3	0
RAPID/BOULDERS	6	174	2.0	0.13	343	0	0	14	33	46	7	0
STEP/LOG	6	7	3.0	0.13	23	0	0	7	66	27	0	0
Total:	26	496	2.4	0.20	998	0	Avg: 0	15	50	31	3	0

HABITAT SUMMARY									
Habitat Group	Number Units	Total Length (m)	Avg Width (m)	Avg Depth (m)	Wetted Area		Large Boulders		
					(m ²)	Percent	Number	(# / 100m ²)	
Dammed & BW Pools	1	2	1.0	0.45	2	0.20%	0	0.0	
Scour Pools	5	11	2.8	0.43	32	3.17%	0	0.0	
Glides	0	0			0	0.00%	0	0.0	
Riffles	0	0			0	0.00%	0	0.0	
Rapids	6	174	2.0	0.13	343	34.35%	0	0.0	
Cascades	7	293	2.2	0.14	585	58.62%	0	0.0	
Step/Falls	6	7	3.0	0.13	23	2.28%	0	0.0	
Dry	0	0			0	0.00%	0	0.0	
Culverts	1	9	1.5	0.10	14	1.38%	0	0.0	

POOL SUMMARY			
	<u>Total</u>	<u>Total of all Channel Lengths # / Km</u>	<u>Primary Channel Length # / Km</u>
All Pools:	6	12.1	12.1
Pools >=1m deep:	0	0.0	0.0
Complex pools (LWD pieces>=3):	1	2.0	2.0
Pool frequency (channel widths/pool):	22.4		
Residual pool depth (avg):	0.29		

Comment Summary

Restoration Monitoring Sites 2007

MONITORING AREA: 1-NC SITE ID: 344 MUNSON CREEK TRIBUTARY B PRE-

UNIT#	TYPE	CHAN	DIST. (m)	COMMENTS	NOTE ESTIMATOR
2	CC	00	33.7	CC	CULVERT, NO SUBSTRATE
4	RB	00	104.5		CUT WOOD OF LARGE DIAMETER
10	SL	01	174.4		LOG OVER CHANNEL CREATING A SH
12	CB	00	213.9		SLOPE ESTIMATED, COULDN'T SEE
19	CB	00	347.05		EST SLOPE
20	SL	00	350.05		TH
21	CB	00	391.75		EST SLOPE
24	CB	00	443.25		EST SLOPE
26	CB	00	494.25		EST SLOPE

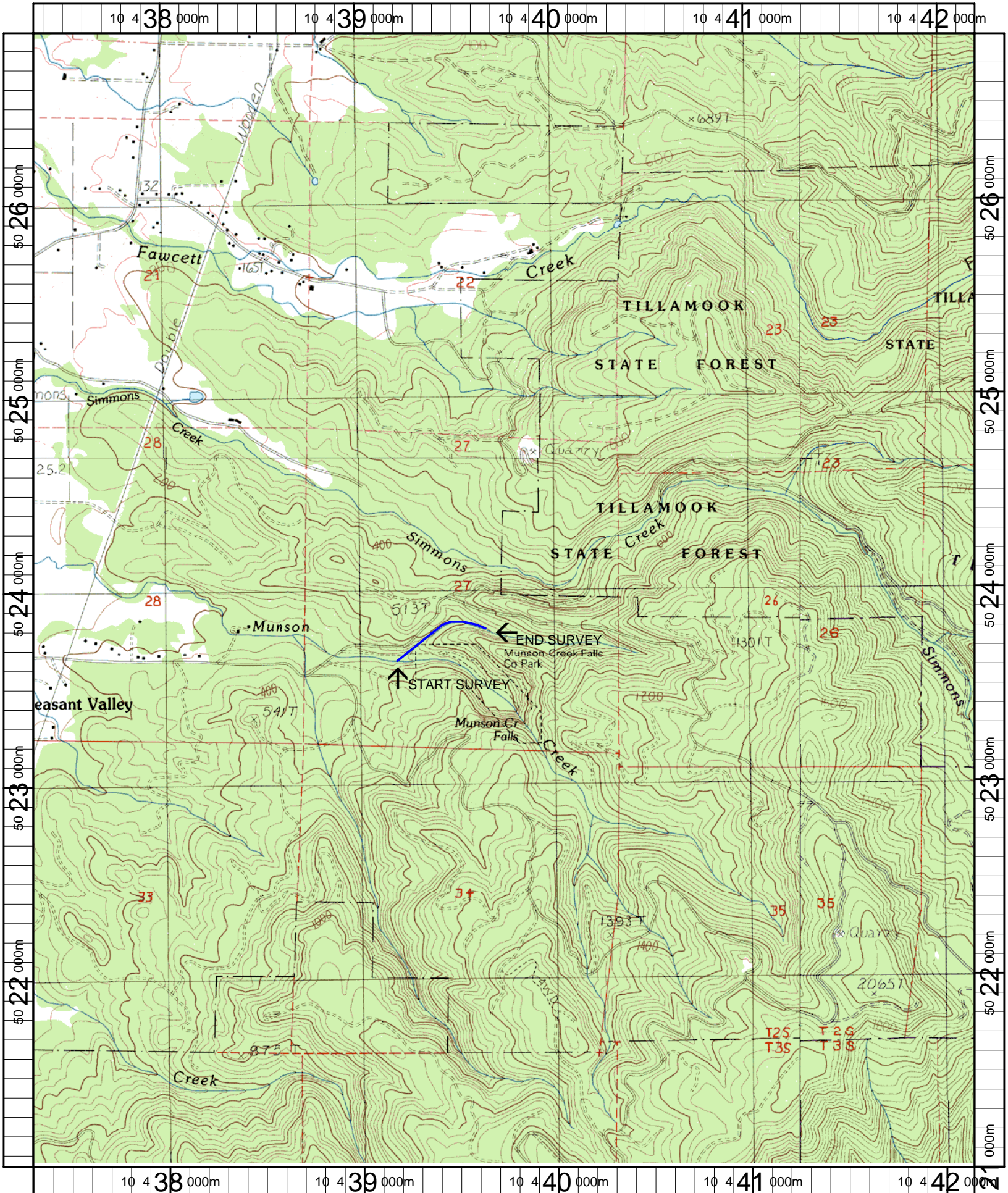

Name: BEAVER
 Date: 1/9/2007
 Scale: 1 inch equals 2000 feet

Location: 10 439744 E 5023946 N
 Caption: MUNSON CREEK TRIBUTARY B RESTORATION SITE -
 TILLAMOOK BASIN